

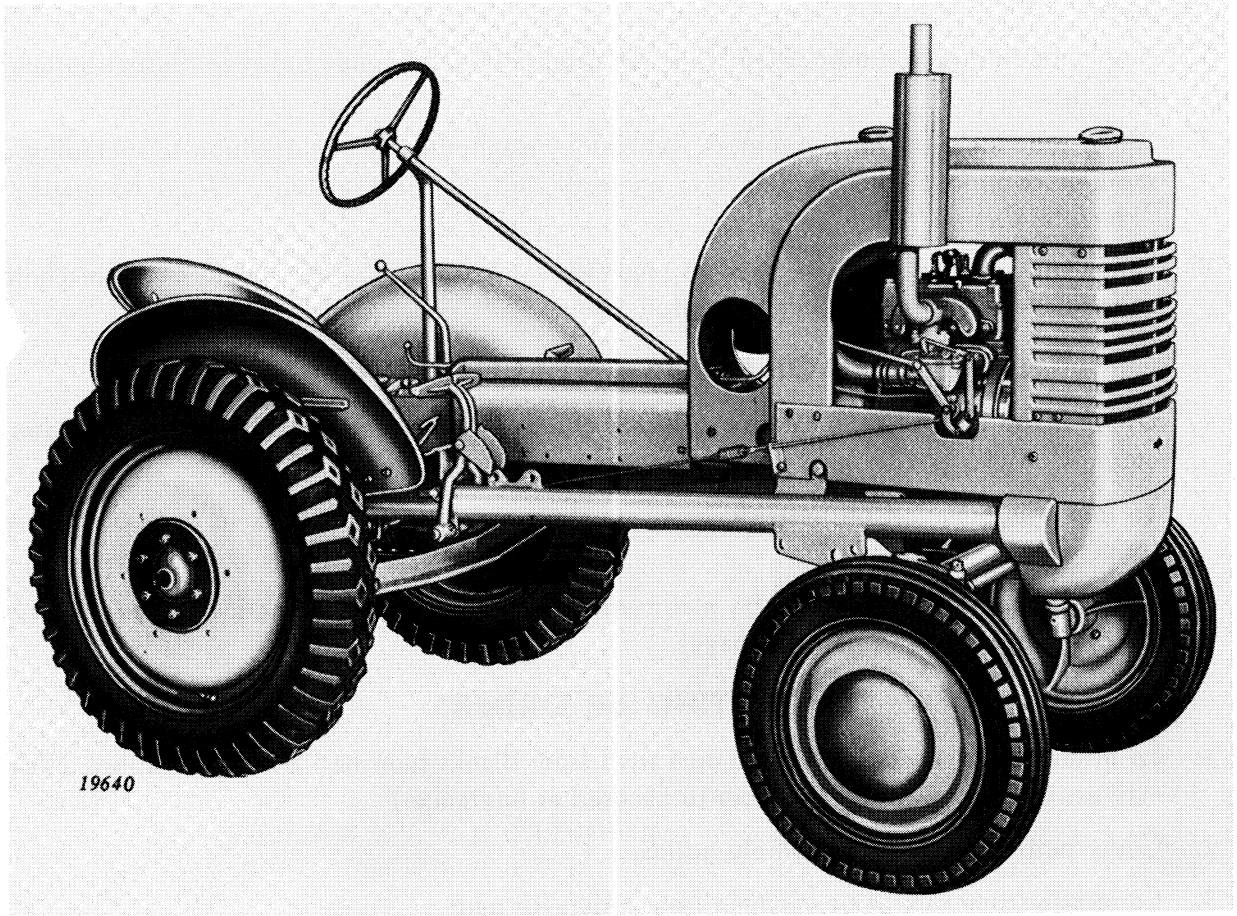

JOHN DEERE
Parts Catalog

MODEL LI TRACTOR

PC152



John Deere Model "LI" Tractor



ORDERING JOHN DEERE PARTS FROM THE BRANCH HOUSE

PART AND KEY NUMBERS

1. Order by part numbers **exactly** as shown in catalog including prefix and suffix letters. Be especially cautious when ordering such items as lock washers, rivets, bolts, and other hardware.
2. Key numbers should not be listed. They are used only as reference between illustrations and parts lists.
3. When ordering parts for carburetors, generators, magnetos, etc., in addition to including a short description of the part, include name of unit, as for example—"Wico Magneto," "Hercules Engine," etc.
4. When ordering items not on hand or regularly carried in stock, be sure to check machine and vintage (date or serial number) information.

USE OF PARTS CATALOG INDEX

1. Use index in front of each catalog to locate groups of parts such as axles, beams, cylinders, etc.
2. To locate information on individual part numbers, use numerical index in back of catalog (printed on yellow pages.)
3. Orders for parts should never be made up from information in numerical index—always refer to illustration and parts list pages.

WRITING UP ORDERS

1. To insure quick service, use Standard Parts Order Blanks furnished by branch house. (You may assign your own order number to be used as reference.)
2. Order parts separately from whole goods.
3. Correspondence should be separate from orders for parts.
4. List part numbers in alphabetical and numerical sequence by factory lines (which can be determined by the last suffix letter after each part number.)
5. Write or print information on orders plainly.

SHIPPING INFORMATION

1. Specify how goods are to be shipped—whether by Freight (specify routing), Truck (specify carrier), Express, Air Express, Parcel Post, or Air Parcel Post.
2. Telegraph orders should give shipping instructions. Shipment will be made by Express or Parcel Post unless otherwise specified.
3. Send order to branch house. Do not order directly from factory.

IF NO PART NUMBER OR DESCRIPTION IS AVAILABLE

If part number cannot be located, send a sketch or return the broken part (shipping charges prepaid) to the branch house. Give the branch house parts department all information available concerning the name of the machine, age or serial number, location and description of part or numbers of adjacent parts, so new part can be identified and shipped quickly.

HOW TO USE THE INDEXES

A printed index on page 5 is for those who are familiar with the nomenclature of the parts of the tractor.

AN EXPLANATION OF SERIAL NUMBER LISTING

Serial number information given on any page is applicable only to parts listed and illustrated on that page.

When the parentheses include only the dash (-)
the part is used on all machines.

When a serial number appears before the dash (IL00000-)
the part was introduced with that serial number and is still being used.

When a serial number appears after the dash (-IL50000)
the part was used up to that serial number but was not used after that serial number.

When serial numbers appear both before and after the dash (IL00000-IL50000)
the part was used beginning with the first serial number, but was not used after the second serial number.



TRACTOR—MODEL "LI"
MEMORANDA



INDEX

	Page		Page
Air Cleaner Assembly	20-21	Hardware Section	48-49-50
Axle, Front	43	Hexagon Nuts	49
Battery Mounting and Cables	25	High Transport Speed Attachment	46
Bearing Inserts Front and Rear Main	8-9	Hose, Air Cleaner	20-21
Belt Fan	18-19	Hoses, Radiator	18-19
Belt, Pulley Attachment	45	Hubcap	44
Block, Cylinder	6-7	Hub, Fan	18-19
Bolt, Machine	49	Lights, Switch, Battery Mounting Cables	25
Brake Assembly	40	Line, Fuel	24
Bushing, Camshaft	11	Lines, Engine Oil Pump	14-15
Cables, Battery	25	Lock Washers	50
Cables, Magneto	26-27-28-29	Lubricating Oil Pump and Oil Lines	14-15
Camshaft, Valves and Associated Parts	11	Magneto, AL2908T, and Cables	26-27
Cap, Gasoline	24	Magneto, AL20274T, and Cables	28-29
Cap Screws	48	Manifold, Exhaust	6-7
Carburetor	22-23	Motor, Starting	32-33
Choke Control	22-23	Muffler	10-11
Clamp, Water Hose	18-19	Nut, Hexagon	49
Cleaner, Air	20-21	Oil Pan and Associated Parts	12
Clutch and Flywheel Assembly	13	Pan, Flywheel	12
Clutch Housing Assembly	37	Pan, Oil	12
Connecting Link, Governor	16-17	Pin, Cotter	50
Connecting Rods	8-9	Pistons	8-9
Cooling Fan, Radiator, and Associated Parts	18-19	Pressure Plate, Clutch	13
Cover, Front Gear	6-7	Propeller Shaft, Guard and Associated Parts	36
Cover, Valve	6-7	Pulley, Belt	45
Crank, Starting	8-9	Pump, Lubricating Oil	14-15
Crankshaft, Connecting Rods, Pistons, and Associated Parts	8-9	Radiator	18-19
Cylinder Block and Associated Parts	6-7	Ring, Piston	8-9
Cylinder Head, Muffler, and Associated Parts	10-11	Rod, Connecting	8-9
Decalcomania Set	47	Rod, Governor Control	16-17
Differential Assembly	38-39	Screw, Cap	48
Disk, Clutch	13	Screw, Machine	49
Drawbar, Assembly	45	Seat, Frame, and Fenders	34-35
Engine Housing	24	Shaft, Final Drive	41
Exhaust, Manifold	6-7	Shaft, Propeller	36
Facing, Clutch	13	Sickle Carrier	46
Fan	18-19	Spark Plugs	10-11
Fenders	34-35	Standard and 50" Front Axle Assemblies	43
Final Drive Assembly	41	Starting Motor	32-33
Fittings, Pipe	50	Steering Gear Assembly	42
Flywheel and Clutch Assembly	13	Support, Engine House	24
Frame, Tractor	34-35	Support, Fuel Tank	24
Front and Rear Wheels and Associated Parts	44	Tank, Fuel	24
Front Axle	43	Tool Box and Sickle Carrier Assembly	46
Fuel Tank, Fuel Filter and Engine Housing	24	Transmission-Differential Assembly	38-39
Gasket, Cylinder Head	10-11	Valve Cover	6-7
Gasket, Carburetor Bowl	22-23	Valve, Exhaust	11
Gasket, Governor	16-17	Valve, Intake	11
Gasket, Manifold	6-7	Washers, Lock	50
Gear, Camshaft	11	Washer, Plain	50
Gear, Crankshaft	8-9	Wheels, Front and Rear	44
Gear, Idlershaft	8-9		
Gears, Transmission	38-39		
Generator	30-31		
Governor	16-17		
Guard, Propeller Shaft	36		

TRACTOR—MODEL "LI"

CYLINDER BLOCK AND ASSOCIATED PARTS

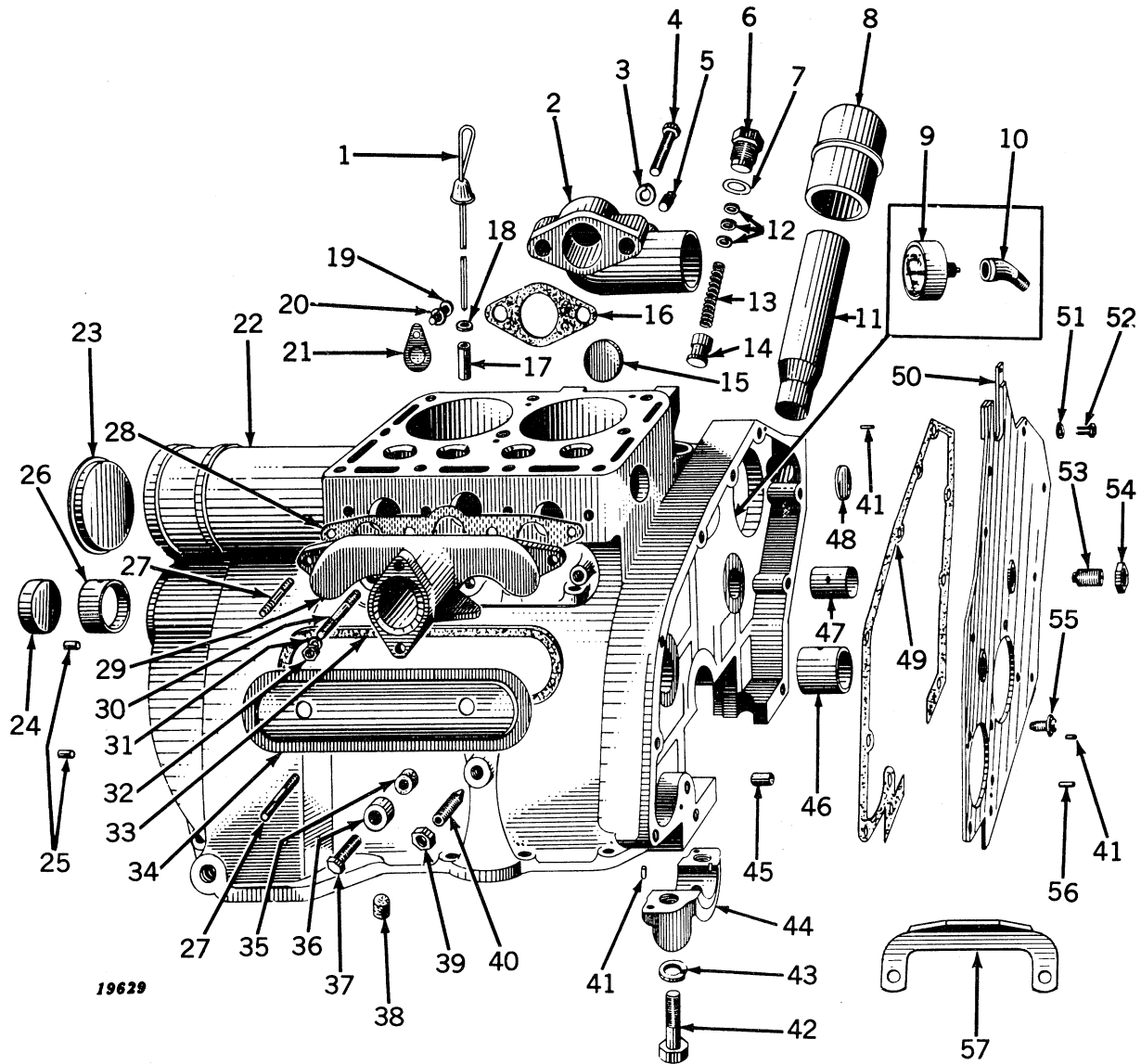

CYLINDER BLOCK AND ASSOCIATED PARTS —Continued

Key	Part No.	Serial No.	Description
1	AL 2722 T	(-)	Gauge, Oil, Bayonet, with Felt Washer
2	AL 2349 T	(-)	Elbow, Water, Lower, with Plug
3	12H 13 R	(-)	Washer, Lock, Water Elbow to Cylinder Block Screws, 1/2" SAE Medium (2 Used)
	AA 3404 R	(-)	Washer, Lock, Water Elbow to Cylinder Block Screws, 1/2" SAE Medium (Box of 50)
4	19H 467 R	(-)	Screw, Cap, Water Elbow to Cylinder Block, 1/2"—13NC2 x 1-3/4" (2 Used)
5	15H 254 R	(-)	Plug, Drain, Lower Water Elbow, 1/4" Square Head Pipe Plug
6	L 4122 T	(-)	Plug, Screw, Oil Pressure Regulating
7	L 754 T	(-)	Gasket, Oil Pressure Regulating Screw Plug
8	AM 669 T	(-)	Cap, Breather
9	AL 2811 T	(-)	Gauge, Oil Pressure
10	15H 219 T	(-)	Elbow, Oil Pressure Gauge, 1/8"—45° Street Elbow
11	AL 2726 T	(-)	Tube, Breather
12	L 4232 T	(-)	Washer, Oil Pressure Regulating (1 to 3 Used)
13	L 752 T	(-)	Spring, Oil Pressure Regulating
14	L 4233 T	(-)	Piston, Oil Pressure Regulating
15	L 4613 T	(-)	Plug, Expansion, on Side of Cylinder Block
16	L 876 T	(-)	Gasket, Lower Water Elbow
17	L 4263 T	(-)	Bushing, Bayonet Oil Gauge
18	L 4256 T	(-)	Washer, Felt, Bayonet Oil Gauge
19	21H 588 T	(-)	Screw, Machine, Timing Hole Cover, 1/4"—20NC2 x 3/8", Rd. Hd.
20	12H 9 R	(-)	Washer, Lock, Timing Hole Cover Screw, 1/4" SAE Medium
	AA 3400 R	(-)	Washer, Lock, Timing Hole Cover Screw, 1/4" SAE Medium (Box of 50)
21	L 689 T	(-)	Cover, Timing Hole
22	AL 2871 T	(-)	Block, Cylinder, with Camshaft Bearings, Idler Shaft Bearings and Set of Gaskets; Less Crankshaft Bearing Inserts
23	L 4225 T	(-)	Cover, Starter Opening
24	L 4140 T	(-)	Plug, Cupped, at Rear of Camshaft
25	L 4126 T	(-)	Pin, Dowel, Rear Oil Seal Plate to Cylinder Block (2 Used)
26	AL 4278 T	(-)	Bushing, Camshaft, Rear
27	L 851 T	(-)	Stud, Short, Manifold to Cylinder Block and Manifold Elbow to Manifold (4 Used)
28	L 4135 T	(-)	Gasket, Manifold
29	AL 2841 T	(-)	Manifold with Muffler Attaching Studs
30	L 4291 T	(-)	Stud, Long, Manifold to Cylinder Block (2 Used)
31	L 853 T	(-)	Washer, Manifold to Cylinder Block and Manifold Elbow to Manifold Screws (Special) (6 Used)
32	L 852 T	(-)	Nut, Brass, Manifold to Cylinder Block and Manifold Elbow to Manifold (Special) (6 Used)
33	L 831 T	(-)	Gasket, Valve Cover
34	L 830 T	(-)	Cover, Valve
35	L 4734 T	(-)	Gasket, Valve Cover Cap Screws (2 Used)
36	L 4183 T	(-)	Retainer, Gasket, Valve Cover Cap Screws (2 Used)
37	19H 211 R	(-)	Screw, Cap, Valve Cover to Cylinder Block, 3/8"—16NC2 x 1" (2 Used)
38	L 4571 T	(-)	Plug, Cork, Above Oil Pan Gasket
39	14H 471 T	(-)	Nut, Hex. Jam, Oil Pump Screw, 1/2"—13NC2
40	L 4121 T	(-)	Screw, Hex., Socket, Oil Pump to Cylinder Block, 1/2"—NC2 Cone Point
41	L 4128 T	(-)	Pin, Dowel, Short, Main Bearing Cap and Gear Cover to Cylinder Block (4 Used)
42	L 4241 T	(-)	Screw, Cap, Main Bearing Cap (Special) (4 Used)
43	12H 14 R	(-)	Washer, Lock, Main Bearing Cap Screws, 9/16" SAE Medium (4 Used)
	AA 3405 R	(-)	Washer, Lock, Main Bearing Cap Screws, 9/16" SAE Medium (Box of 25)
44	AL 20124 T	(-)	Cap, Main Bearing (Special Repair Cap) (2 Used)
45	L 4266 T	(-)	Bushing, Governor Shaft, Rear
46	AL 4277 T	(-)	Bushing, Camshaft, Front
47	L 4179 T	(-)	Bushing, Idler Shaft
48	30H 17 R	(-)	Plug, Expansion, on Ends of Cylinder Block, 1-1/4" Dia. (2 Used)
49	L 4134 T	(-)	Gasket, Gear Cover
50	AL 2663 T	(-)	Cover, Gear, with Thrust Screws and Governor Dowel Pin
51	12H 11 R	(-)	Washer, Lock, Gear Cover to Cylinder Block Screws, 3/8" SAE Medium (8 Used)
	AA 3402 R	(-)	Washer, Lock, Gear Cover to Cylinder Block Screws, 3/8" SAE Medium (Box of 50)
52	19H 207 T	(-)	Screw, Cap, Gear Cover to Cylinder Block, 3/8"—16NC2 x 7/8" (8 Used)
53	AL 2660 T	(-)	Screw, Thrust, Camshaft and Idler Shaft, in Gear Cover (2 Used)
54	14H 344 A	(-)	Nut, Hex. Jam, Thrust Screws in Gear Cover, 7/16" (2 Used)
55	L 4161 T	(-)	Screw, Front Oil Seal Plate to Cylinder Block (Special) (3 Used)
56	L 4129 T	(-)	Pin, Dowel, Long, Gear Cover and Governor to Cylinder Block
57	L 4164 T	(-)	Support, Engine, Front
Parts listed below are not illustrated.			
	L 4168 T	(-)	Screw, Starter Attaching
	14H 477 T	(-)	Nut, Hex. Jam, Starter Attaching Screw, 5/8"
	29H 25 T	(-)	Nipple, Pipe, Oil Pressure Gauge, 1/8" x 3"
	15H 197 R	(-)	Elbow, Street, Oil Pressure Gauge, 1/8"—90° Street Elbow (2 Used)



TRACTOR—MODEL "LI"

CRANKSHAFT, CONNECTING RODS, PISTONS, AND ASSOCIATED PARTS

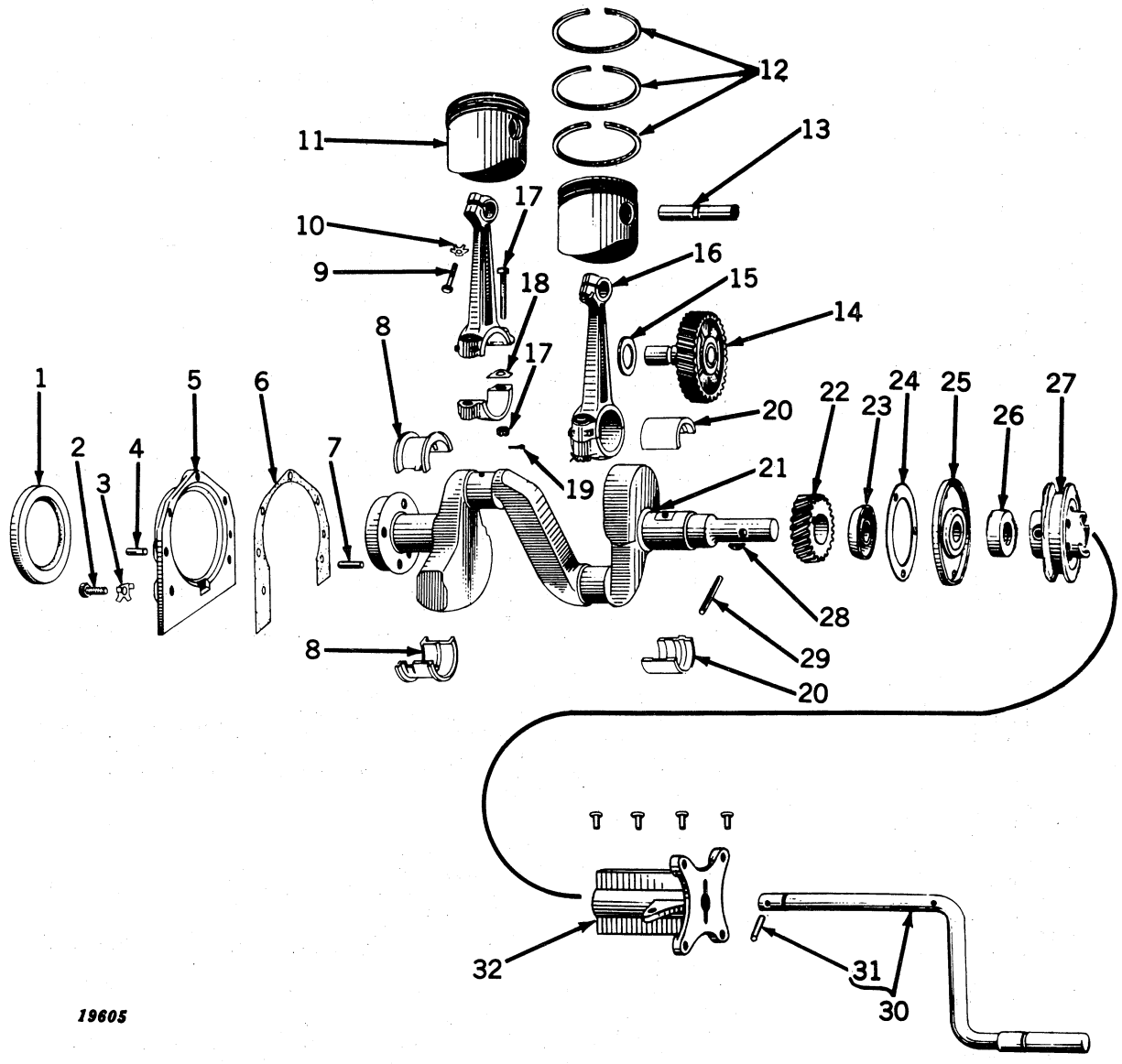

19605



CRANKSHAFT, CONNECTING RODS, PISTONS, AND ASSOCIATED PARTS—Continued

Key	Part No.	Serial No.	Description
1	AT 195 T	(-)	Seal, Oil, Crankshaft, Rear (Sub. for AL2654T)
2	19H 105 R	(-)	Screw, Cap, Rear Oil Seal Plate to Cylinder Block, 5/16"—18NC2 x 3/4" (5 Used)
3	L 4187 T	(-)	Lock, Rear Oil Seal Plate to Cylinder Block Screws (5 Used)
4	L 4126 T	(-)	Pin, Dowel, Rear Oil Seal Plate to Cylinder Block (2 Used)
5	AL 2743 T	(-)	Plate, Oil Seal, Crankshaft, Rear, with Oil Seal
6	L 4132 T	(-)	Gasket, Rear Oil Seal Plate
7	L 4127 T	(-)	Pin, Dowel, Flywheel to Crankshaft
8	AL 2882 T	(-)	Inserts, Rear, Main Bearing, Standard (2 Halves)
	AL 2884 T	(-)	Inserts, Rear, Main Bearing, .003" Undersize (2 Halves)
	AL 2886 T	(-)	Inserts, Rear, Main Bearing, .005" Undersize (2 Halves)
9	AL 2760 T	(-)	Screw, Clamp, with Lock, Piston Pin (2 Used)
10	L 4208 T	(-)	Lock, Piston Pin Clamp Screw (2 Used)
11	AL 2347 T	(-)	Piston with Rings, Piston Pin and Piston Pin Bushings, 3-1/4" Standard (2 Used)
	AL 2348 T	(-)	Piston with Rings, Piston Pin and Piston Pin Bushings 3-1/4" —.020" Oversize (2 Used)
12	AL 2890 T	(-)	Rings, Piston, 3-1/4" Standard (Set of 6) (1 Set Used)
	AL 2891 T	(-)	Rings, Piston, 3-1/4"—.020" Oversize (Set of 6) (1 Set Used)
13	L 678 T	(-)	Pin, Piston (2 Used)
14	AL 2677 T	(-)	Shaft, Idler, with Gear and Thrust Plug
15	L 803 T	(-)	Washer, Thrust, Idler Shaft
16	AL 2759 T**	(-)	Rod, Connecting, with Bolts, Nuts, Cotter Pins, Piston Pin Clamp Screw and Screw Lock (2 Used)
17	AL 2869 T	(-)	Bolt and Nut Assembly with Cotter Pins (Complete Set for one Connecting Rod) (2 Used)
18	L 779 T	(-)	Shim, Connecting Rod to Cap, .003" (As needed)
	L 780 T	(-)	Shim, Connecting Rod to Cap, .002" (As needed)
19	11H 19 R	(-)	Pin, Cotter, 3/32" x 5/8" (4 Used)
20	AL 2881 T	(-)	Inserts, Front, Main Bearing, Standard (2 Halves)
	AL 2883 T	(-)	Inserts, Front, Main Bearing, .003" Undersize (2 Halves)
	AL 2885 T	(-)	Inserts, Front, Main Bearing, .005" Undersize (2 Halves)
21	AL 2699 T	(-)	Crankshaft with Timing Gear
22	AL 766 T	(-)	Gear, Crankshaft, Timing
23	L 768 T	(-)	Thrower, Oil, Crankshaft
24	L 4152 T	(-)	Gasket, Front Oil Seal Plate to Gear Cover
25	L 4115 T	(-)	Plate, Oil Seal, Crankshaft, Front
26	AL 2653 T	(-)	Seal, Oil, Crankshaft, Front
27	AL 2877 T	(-)	Pulley, Fan Drive with Groov-Pin
28	26H 11 T	(-)	Key, Woodruff, 3/16" x 5/8" (2 Used)
29	25H 125 T	(-)	Pin, Groov-, Fan Drive Pulley to Crankshaft, 5/16" x 1-3/4", Type No. 1
30	AL 2285 T	(-)	Crank, Starting, with Crank Pin
31	M 1437 T	(-)	Pin, Starting Crank
32	AL 2421 T	(-)	Guide, Starting Crank with Four Rivets

**Exchange Connecting Rod. New Connecting Rod may be purchased at Reduction if old Rod is sent in with order. Orders Not including old connecting rod will be billed at Full price.



CYLINDER HEAD, MUFFLER, AND ASSOCIATED PARTS

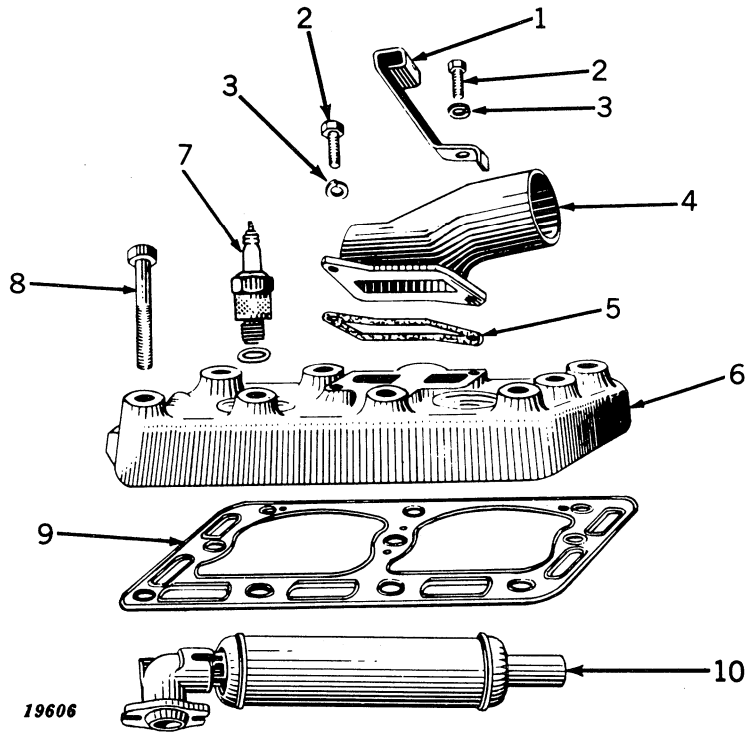

Key	Part No.	Serial No.	Description
1	L 4290 T	(-)	Bracket, Spark Plug Cable
2	19H 211 R	(-)	Screw, Cap, 3/8"—16NC2 x 1" (2 Used)
3	12H 11 R	(-)	Washer, Lock, 3/8" SAE Medium (2 Used)
	AA 3402 R	(-)	Washer, Lock, 3/8" SAE Medium, (Box of 50)
4	AL 4116 T	(-)	Elbow, Water, Upper
5	L 4117 T	(-)	Gasket, Upper Water Elbow
6	AL 4106 T	(-)	Head, Cylinder
7	AM 514 T	(-)	Plug, Spark, Champion Type H10 (2 Used)
	AM 1535 T	(-)	Plug, Spark, AC Type, 45L (2 used)
	AM 1536 T	(-)	Plug, Spark, Auto-Lite Type AN7F (2 Used)
8	L 4136 T	(-)	Screw, Cap, Cylinder Head (Special) (10 Used)
9	AL 2651 T	(-)	Gasket, Cylinder Head
10	AL 2812 T	(-)	Muffler Assembly



CAMSHAFT, VALVES AND ASSOCIATED PARTS

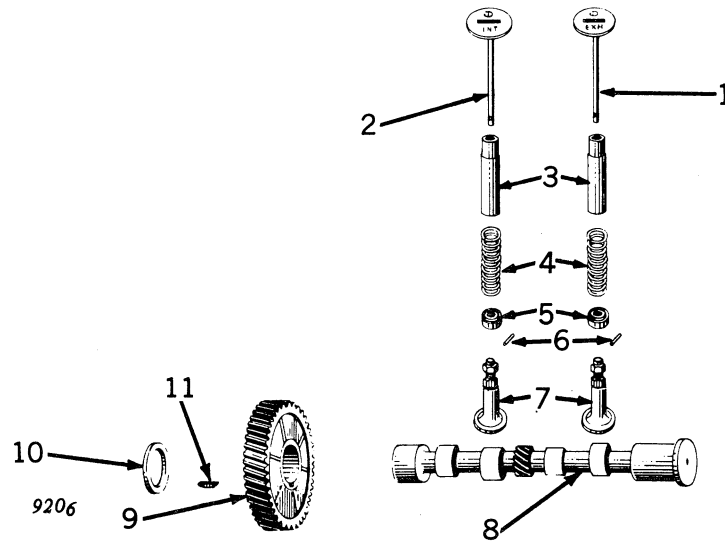

Key	Part No.	Serial No.	Description
1	AL 822 T	(-)	Valve, Exhaust (2 Used)
2	AL 821 T	(-)	Valve, Intake (2 Used)
3	L 826 T	(-)	Guide, Valve (4 Used)
4	L 4593 T	(-)	Spring, Valve (4 Used)
5	L 824 T	(-)	Seat, Valve Spring (4 Used)
6	L 825 T	(-)	Pin, Valve Retainer (4 Used)
7	AL 2675 T	(-)	Tappet, Valve, with Adjusting Screw (4 Used)
8	AL 2756 T	(-)	Camshaft with Thrust Plug
9	AL 787 T	(-)	Gear, Camshaft Timing
10	L 789 T	(-)	Washer, Thrust, Camshaft
11	26H 11 T	(-)	Key, Woodruff, Camshaft Gear to Camshaft, 3/16" x 5/8" (2 Used)

TRACTOR—MODEL “LI”
OIL PAN AND ASSOCIATED PARTS

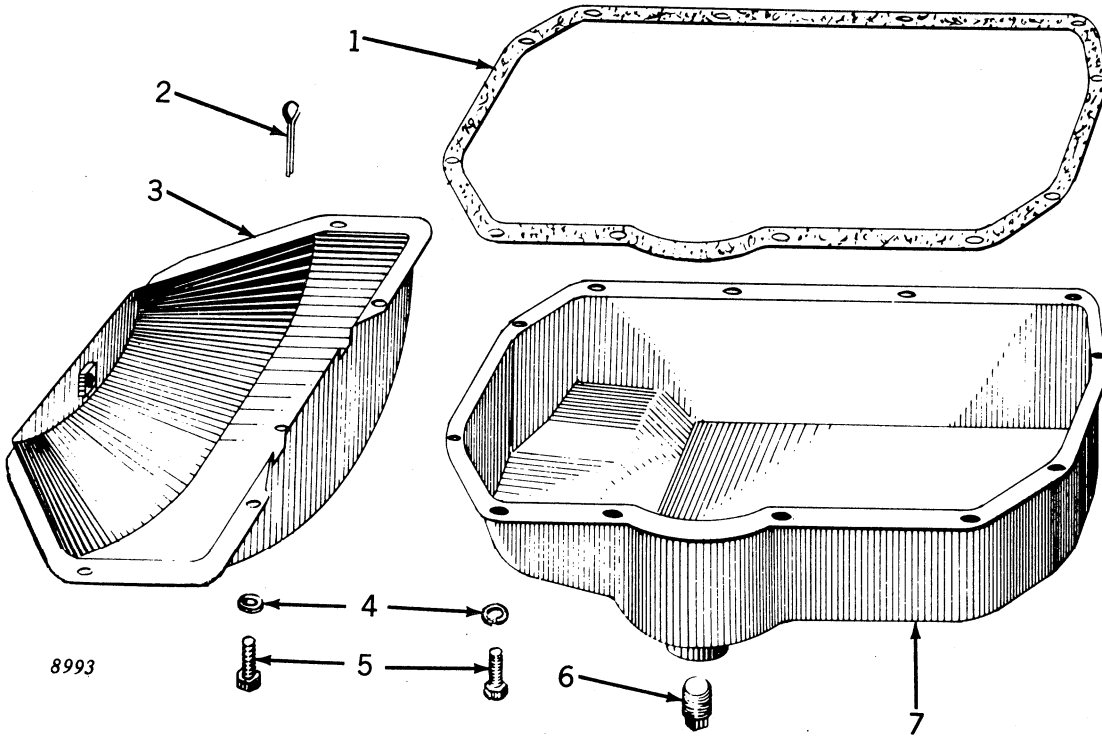

8993

Key	Part No.	Serial No.	Description
1	L 4133 T	(-)	Gasket, Oil Pan
2	11H 20 T	(-)	Pin, Cotter, Flywheel Housing Pan Drain Hole, 3/32" x 3/4"
3	AL 2693 T	(-)	Pan, Flywheel Housing
4	12H 10 R	(-)	Washer, Lock, Oil Pan and Flywheel Housing Pan to Cylinder Block
	AA 3401 R	(-)	Screws, 5/16" SAE Medium (16 Used)
5	19H 100 T	(-)	Washer, Lock, Oil Pan and Flywheel Housing Pan to Cylinder Block
		(-)	Screws, 5/16" SAE Medium (Box of 50)
6	15H 257 T	(-)	Screw, Cap, Oil Pan and Flywheel Housing Pan to Cylinder Block, 5/16"—18NC2 x 5/8" (16 Used)
7	AL 2657 T	(-)	Plug, Drain, Oil Pan, 3/4" Pipe Plug



FLYWHEEL AND CLUTCH ASSEMBLY

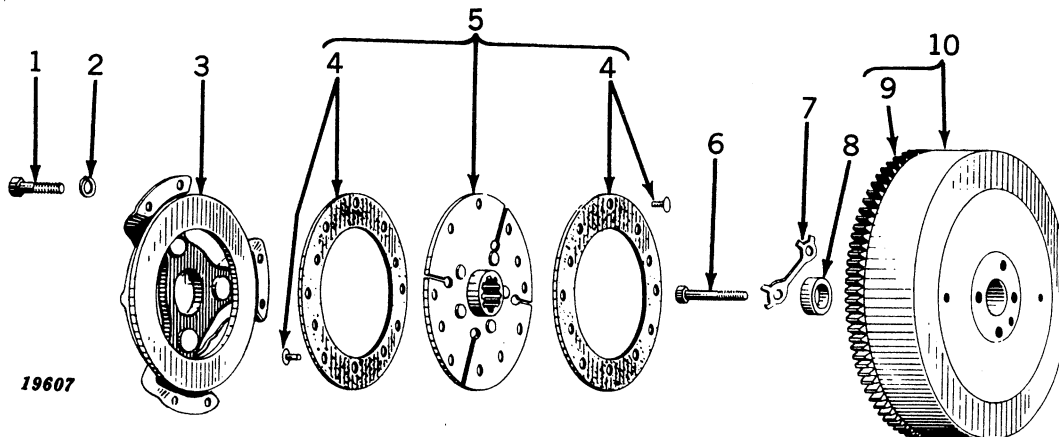

Key	Part No.	Serial No.	Description
1	L 372 T	(-)	Screw, Cap, Clutch Pressure Plate to Flywheel (Special) (6 Used)
2	12H 10 R	(-)	Washer, Lock, Clutch Pressure Plate to Flywheel Screws, 5/16" SAE Medium (6 Used)
	AA 3401 R	(-)	Washer, Lock, Clutch Pressure Plate to Flywheel Screws, 5/16" SAE Medium (Box of 50)
3	AL 2834 T	(-)	Plate, Pressure, Assembly, Clutch
4	AL 2836 T	(-)	Facings, Clutch Driven Disk (2 Facings and Rivets)
5	AL 2835 T	(-)	Disk, Driven, with Facings, Clutch
6	L 4151 T	(-)	Screw, Cap, Flywheel to Crankshaft (Special) (4 Used)
7	L 4139 T	(-)	Lock, Flywheel to Crankshaft Cap Screws (2 Used)
8	AM 1597 T	(-)	Bushing, Clutch Pilot, with Grease Retainer
9	AL 4111 T	(-)	Gear, Ring, Flywheel
10	AL 2826 T	(-)	Flywheel with Pilot Bushing and Ring Gear



LUBRICATING OIL PUMP AND OIL LINES

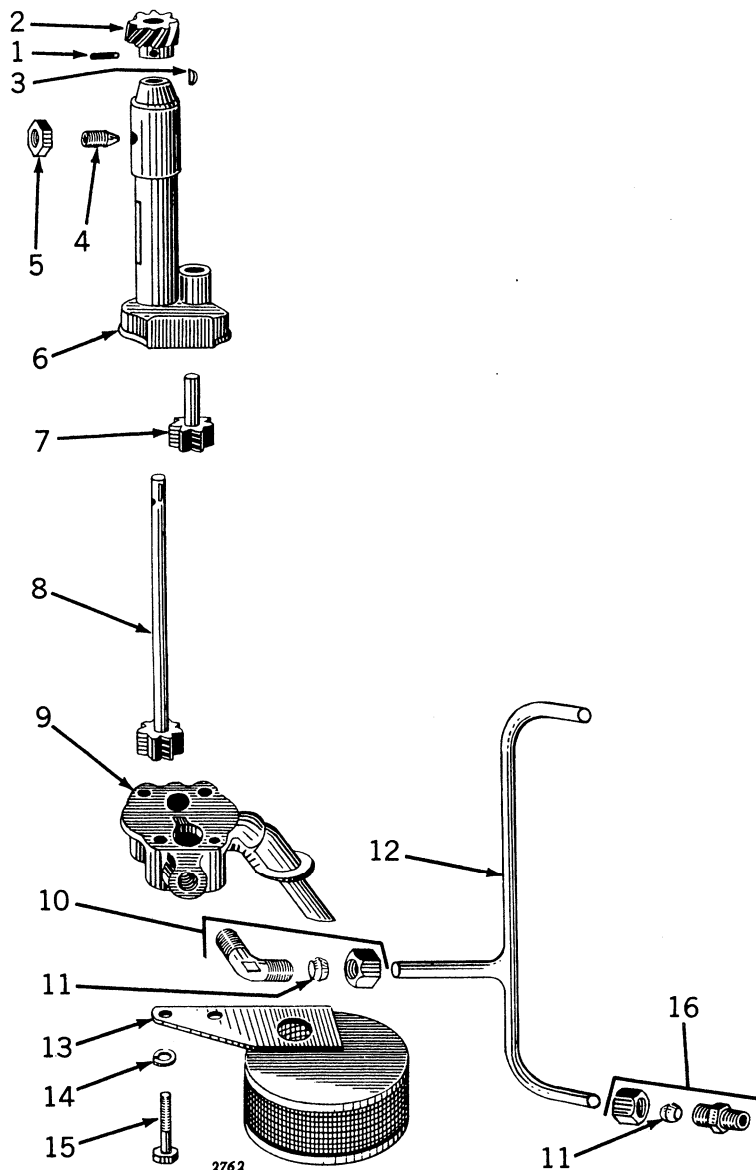

LUBRICATING OIL PUMP AND OIL LINES —Continued

Key	Part No.	Serial No.	Description
1	25H 42 T	(—)	Pin, Groov, Oil Pump Driving Gear, 1/8" x 3/4", Type No. 1
2	L 820 T	(—)	Gear, Drive, Oil Pump
3	26H 6 R	(—)	Key, Woodruff, Oil Pump Drive Gear, 3/32" x 1/2"
4	L 4121 T	(—)	Screw, Set, Oil Pump
5	14H 471 T	(—)	Nut, Hex. Jam, Oil Pump Set Screw, 1/2"—13NC2
6	AL 4173 T	(—)	Body, Oil Pump
7	AL 2668 T	(—)	Shaft, Idler, with Pumping Gear
8	AL 2669 T	(—)	Shaft, Drive, with Pumping Gear
9	AL 2827 T	(—)	Cover with Intake Pipe
10	AL 2728 T	(—)	Elbow with Nut and Ferrule
11	L 836 T	(—)	Ferrule, Oil Line (3 Used)
12	AL 2752 T	(—)	Line, Oil, with 3 Ferrules
13	AL 2136 T	(—)	Strainer, Oil, Assembly
14	12H 9 R	(—)	Washer, Lock, 1/4" SAE Medium (4 Used)
	AA 3400 R	(—)	Washer, Lock, 1/4" SAE Medium (Box of 50)
15	19H 37 T	(—)	Screw, Cap, 1/4"—20NC2 x 1-1/2" (4 Used)
16	AL 2729 T	(—)	Connector, Oil Line, with Nut and Ferrule (2 Used)
..	AL 2750 T	(—)	Pump Assembly, Oil, less Strainer



TRACTOR—MODEL "LI"

GOVERNOR

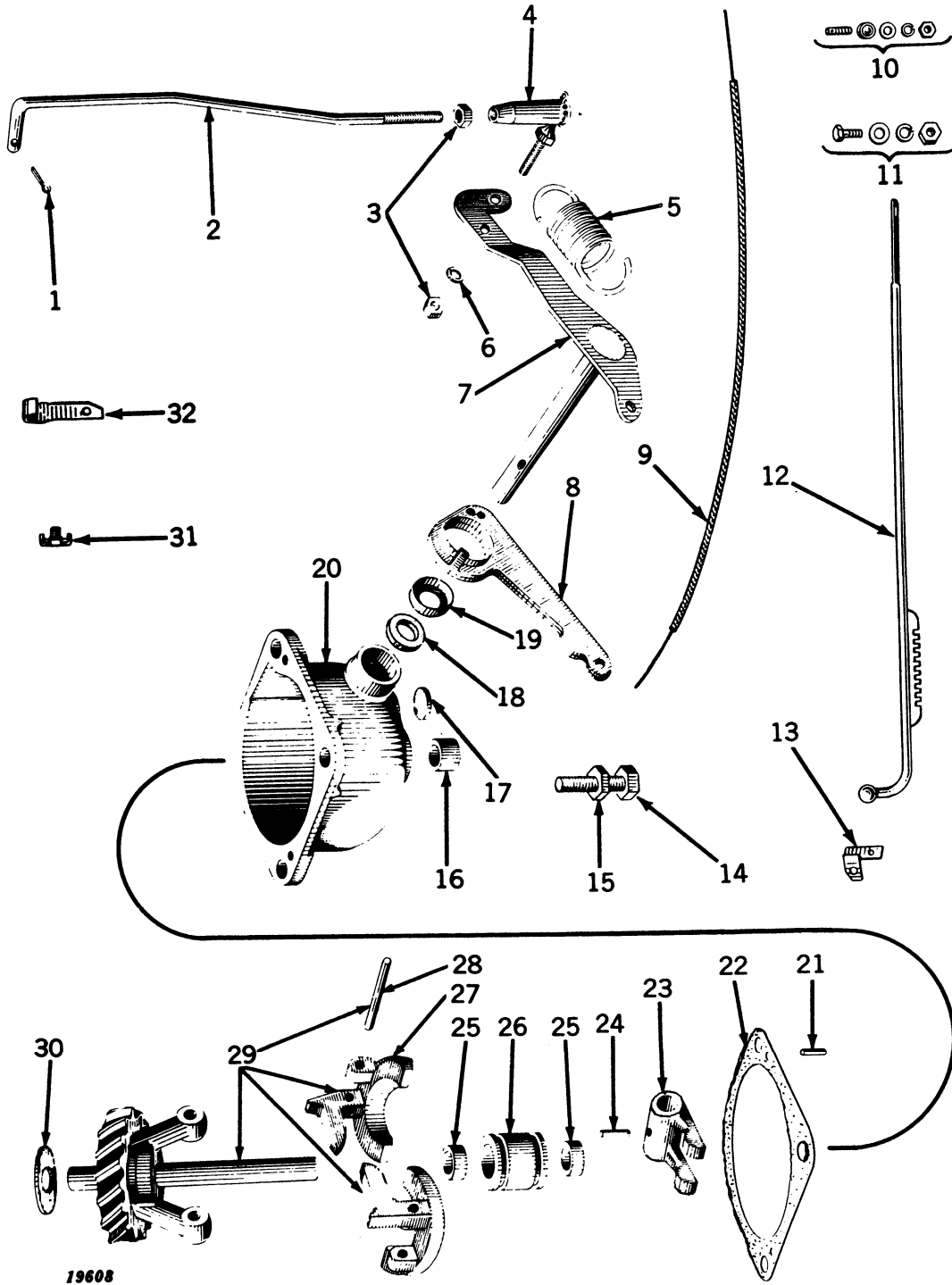

GOVERNOR—Continued

Key	Part No.	Serial No.	Description
1	11H 3 R	(-)	Pin, Cotter, 1/16" x 1/2"
2	L 4244 T	(-)	Rod, Connecting, Governor to Carburetor
3	14H 377 T	(-)	Nut, Hex. Jam, 1/4"-28NF2 (2 Used)
4	AL 2096 T	(-)	Joint, Ball, Assembly, Connecting Rod
5	L 4197 T	(-)	Spring
6	12H 9 R	(-)	Washer, Lock, Connecting Rod Ball Joint Assembly, 1/4" SAE Medium
	AA 3400 R	(-)	Washer, Lock, Connecting Rod Ball Joint Assembly, 1/4" SAE Medium (Box of 50)
7	AL 2667 T	(-)	Lever, Operating and Shaft Assembly
8	AL 2692 T	(-)	Lever, Assembly
9	AL 2725 T	(-)	Cable, Control
10	AL 2754 T	(-)	Swivel Assembly, Control Wire
11	AL 2755 T	(-)	Screw Assembly, Control Rod Clamp
12	AL 2784 T	(-)	Rod, Control, Notched
13	L 4252 T	(-)	Bracket, Governor Cable to Shaft
14	L 4789 T	(-)	Screw, Lever Stop (Special)
15	14H 465 T	(-)	Nut, Hex., 3/8"-16NC2
16	L 4265 T	(-)	Bushing, Governor Shaft, Front
17	30H 7 T	(-)	Plug, Expansion 5/8" Dia.
18	L 4176 T	(-)	Washer, Sealing, Operating Shaft
19	L 4183 T	(-)	Retainer, Seal, Operating Shaft
20	AL 2753 T	(-)	Case with Bushing, Expansion Plug and Seal Assembly
21	L 4129 T	(-)	Pin, Dowel, Long
22	L 4231 T	(-)	Gasket, Governor to Gear Cover
23	L 4158 T	(-)	Fork
24	25H 50 T	(-)	Pin, Groov-, Governor Fork to Shaft 5/32" x 3/4", Type No. 1
25	L 4299 T	(-)	Bushing, Thrust Bearing (2 Used)
26	AL 2691 T	(-)	Bearing, Thrust with 2 Bushings
27	L 4181 T	(-)	Weight, Governor (2 Used)
28	L 4188 T	(-)	Pin, Weight to Shaft (2 Used)
29	AL 2718 T	(-)	Shaft, Governor, with Weights and Gear
30	L 4177 T	(-)	Washer, Gear Thrust
31	L 4294 T	(-)	Clamp, Control Cable
32	L 4311 T	(-)	Clip, Control Cable Rear of Engine
..	AL 2720 T	(-)	Governor, Complete



COOLING FAN, RADIATOR AND ASSOCIATED PARTS

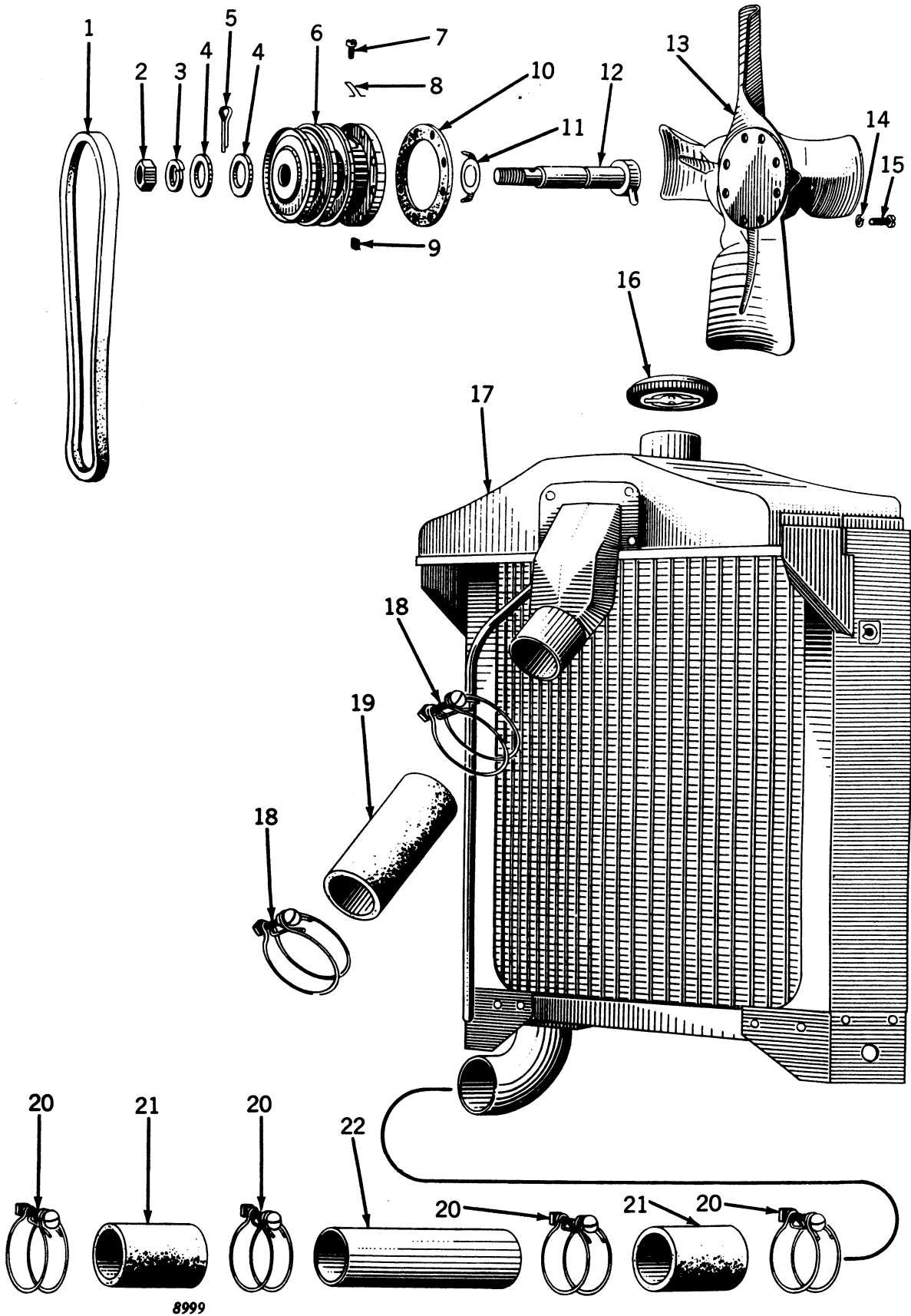

8999



COOLING FAN, RADIATOR AND ASSOCIATED PARTS —Continued

Key	Part No.	Serial No.	Description
1	L 346 T	(—)	Belt, Fan
2	14H 478 T	(—)	Nut, Hex. Jam, Fan to Fan Bracket, 5/8"-18NF2
3	12H 15 R	(—)	Washer, Lock, Fan to Fan Bracket, 5/8" SAE Medium
	AA 3406 R	(—)	Washer, Lock, Fan to Fan Bracket, 5/8" SAE Medium (Box of 25)
4	L 1147 T	(—)	Washer, Fan to Fan Bracket (2 Used)
5	11H 60 T	(—)	Pin, Cotter, 5/32" x 1"
6	AL 2862 T	(—)	Hub, Fan, Assembly
7	L 4368 T	(—)	Plug, Oil Filler, Fan Hub
8	L 4366 T	(—)	Wire, Lock, Oil Filler Plug, Fan Hub
9	14H 644 T	(—)	Nut, Fan Blade to Hub, No. 10-32NF2, Square (8 Used)
10	L 4367 T	(—)	Gasket, Fan Blade to Hub
11	L 908 T	(—)	Washer, Thrust, Bronze
12	AL 2860 T	(—)	Nut Assembly, Spindle and Thrust
13	AL 2864 T	(—)	Blade Assembly
14	12H 7 R	(—)	Washer, Lock, Fan Blade to Hub, No. 10 SAE Medium (8 Used)
15	21H 412 T	(—)	Screw, Fan Blade to Hub, No. 10-32NF2 x 1/2" Fill Hd. (8 Used).
16	AL 2275 T	(—)	Cap, Radiator Filler
17	AL 2266 T	(—)	Radiator
18	AL 2083 T	(—)	Clamp, Upper Water Hose (2 Used)
19	L 338 T	(—)	Hose, Upper Water
20	AL 2090 T	(—)	Clamp, Lower Water Hose (4 Used)
21	L 333 T	(—)	Hose, Lower Water (2 Used)
22	L 365 T	(—)	Tube, Lower Water
..	AL 2687 T	(—)	Fan Assembly, Complete

TRACTOR—MODEL "LI"

AIR CLEANER ASSEMBLY

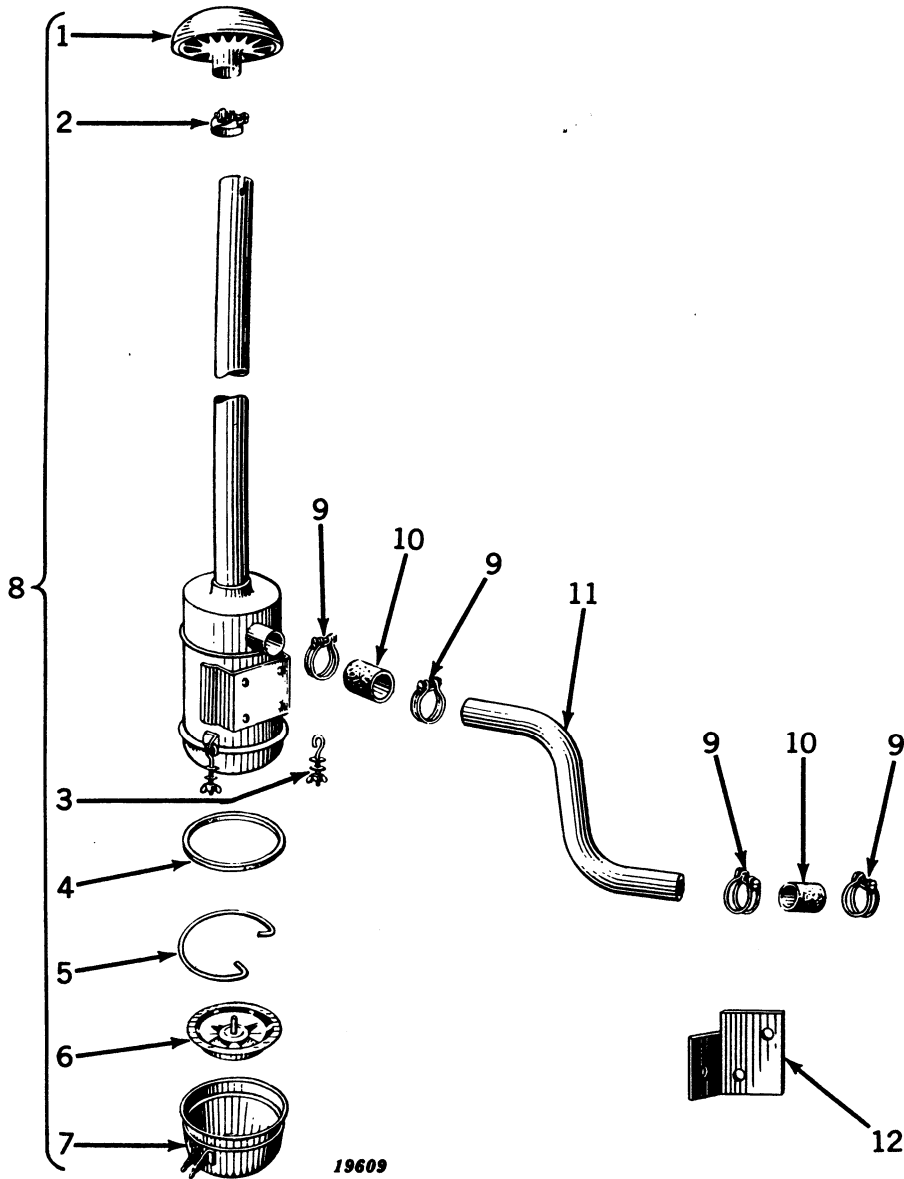

AIR CLEANER ASSEMBLY —Continued

Key	Part No.	Serial No.	Description
1	AL 2442 T	(-)	Cap, Weather
2	AL 20305 T	(-)	Clamp Assembly, Screen Support to Tube (2 Used)
3	AL 20133 T	(-)	Eyebolt Assembly, Air Cleaner Cup (2 Used)
4	L 997 T	(-)	Gasket, Air Cleaner Cup
5	L 995 T	(-)	Ring, Retaining, Baffle Plate
6	AL 2444 T	(-)	Plate, Baffle
7	AL 20306 T	(-)	Cup, Air Cleaner
8	AL 2840 T	(-)	Cleaner Assembly, Air, Complete
9	AL 2090 T	(-)	Clamp, Hose, Air Cleaner to Carburetor (4 Used)
10	L 333 T	(-)	Hose, Rubber, Air Cleaner to Carburetor (2 Used)
11	L 4192 T	(-)	Tube, Air Cleaner to Carburetor
12	L 4316 T	(-)	Plate, Reinforcing, Mounting

TRACTOR—MODEL "LI"

CARBURETOR

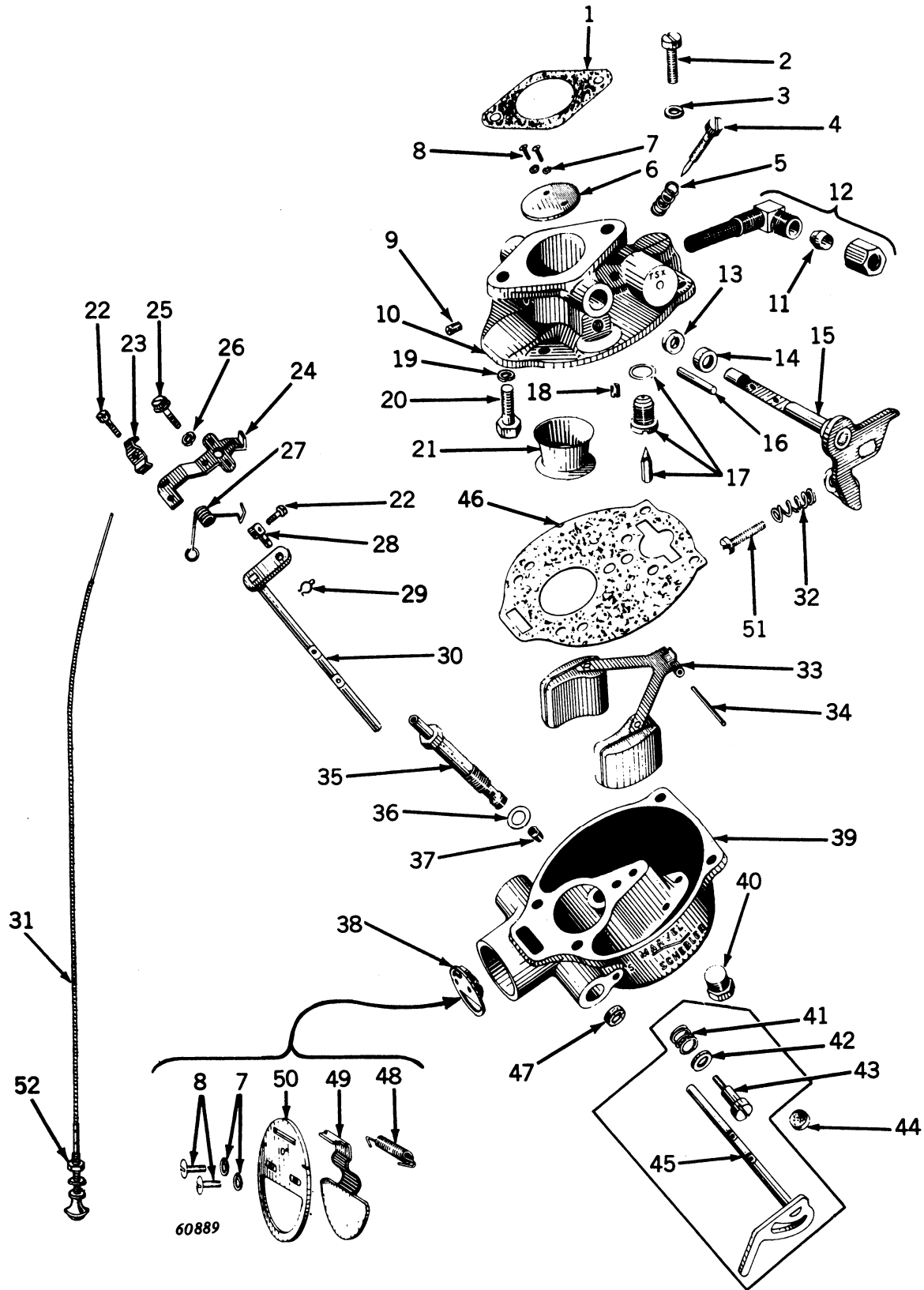

CARBURETOR

Key	Part No.	Serial No.	Description
1	L 681 T	(-)	Gasket, Carburetor Attaching
2	15-443	(-)	Screw, Upper Body to Lower Body (4 Used)
3	78-154	(-)	Washer, Lock, Upper Body to Lower Body Screws (4 Used)
4	43-108†	(-)	Needle, Idle Adjusting
5	24-340†	(-)	Spring, Idle Needle
6	14-175	(-)	Fly, Throttle
7	78-322	(-)	Washer, Lock, Choke and Throttle Fly Screws (4 Used)
8	15-A91†	(-)	Screw, Throttle and Choke Fly (4 Used)
9	15-223	(-)	Screw, Upper Body Plug
10	227-738	(-)	Body Assembly, Throttle, with Throttle Shaft, Fly, and Plugs
11	L 587 T	(-)	Ferrule, Fuel Inlet Line
12	67-523	(-)	Strainer Assembly, Fuel Inlet
13	44-38†	(-)	Packing, Throttle Shaft
14	55-231†	(-)	Retainer, Throttle Shaft Packing
15	13-719†	(-)	Throttle Shaft and Stop Assembly with Throttle Fly
16	62-167	(-)	Pin, Throttle Stop
17	233-536†	(-)	Valve, Float and Seat with Gasket (Matched Set)
18	49-101 L†	(-)	Jet, Idle
19	12H 10 R	(-)	Washer, Lock, 5/16" (2 Used)
20	19H 110 R	(-)	Screw, Cap, Carburetor to Manifold, 5/16" x 7/8" (2 Used)
21	46-473	(-)	Venturi
22	21H 971 R*	(-)	Screw, Choke Bracket Clamp and Choke Swivel (2 Used)
23	29-81*	(-)	Clamp, Choke Bracket
24	29-530*	(-)	Choke, Bracket Assembly
25	15-33*	(-)	Screw, Choke Bracket Attaching
26	78-62*	(-)	Washer, Lock, Choke Bracket Attaching Screw
27	24-153*	(-)	Spring, Choke Lever
28	28-49*	(-)	Swivel, Choke Lever
29	82-16*	(-)	Wire, Snap, Choke Lever Swivel
30	26-656*	(-)	Shaft, Choke
31	AL 2705 T	(-)	Cable, with Knob Choke Control
32	24-262†	(-)	Spring, Throttle Stop Screw
33	30-600	(-)	Float and Lever Assembly
34	32-27†	(-)	Shaft, Float
35	47-611	(-)	Nozzle, Main
36	16-449†	(-)	Gasket, Nozzle
37	49-209†	(-)	Jet, Power
38	27-539	(-)	Fly, Choke, Assembly
39	10-2182	(-)	Carburetor, Lower Body and Plug Assembly
40	99-7	(-)	Plug, Drain
41	24-480†	(-)	Spring, Choke Lever Stop Screw
42	78-184	(-)	Washer, Choke Lever to Stop Screw
43	15-397	(-)	Screw, Choke Lever Stop
44	95-78	(-)	Strainer, Gasoline Drain
45	26-657	(-)	Shaft, Choke and Lever Assembly (Not used on Tractors with Electric Starter)
46	16-80†	(-)	Gasket, Carburetor Bowl
47	44-39†	(-)	Packing, Choke Shaft (2 Used)
48	24-425†	(-)	Spring, Choke Fly Flapper
49	27-144	(-)	Flapper, Choke Fly
50	27-154	(-)	Fly, Choke
51	21H 977 R	(-)	Screw, Throttle Stop
52	14H 774 R	(-)	Nut, Hex., 3/8"
..	AL 2850 T	(-)	Carburetor Complete
..	286-605	(-)	Kit, Repair, for AL2850T Carburetor (Contains All Part Nos. Followed by a Dagger (†))

*Parts Furnished to John Deere Branch Houses by John Deere Waterloo Tractor Works of Waterloo, Iowa

FUEL TANK, FUEL FILTER, AND ENGINE HOUSING

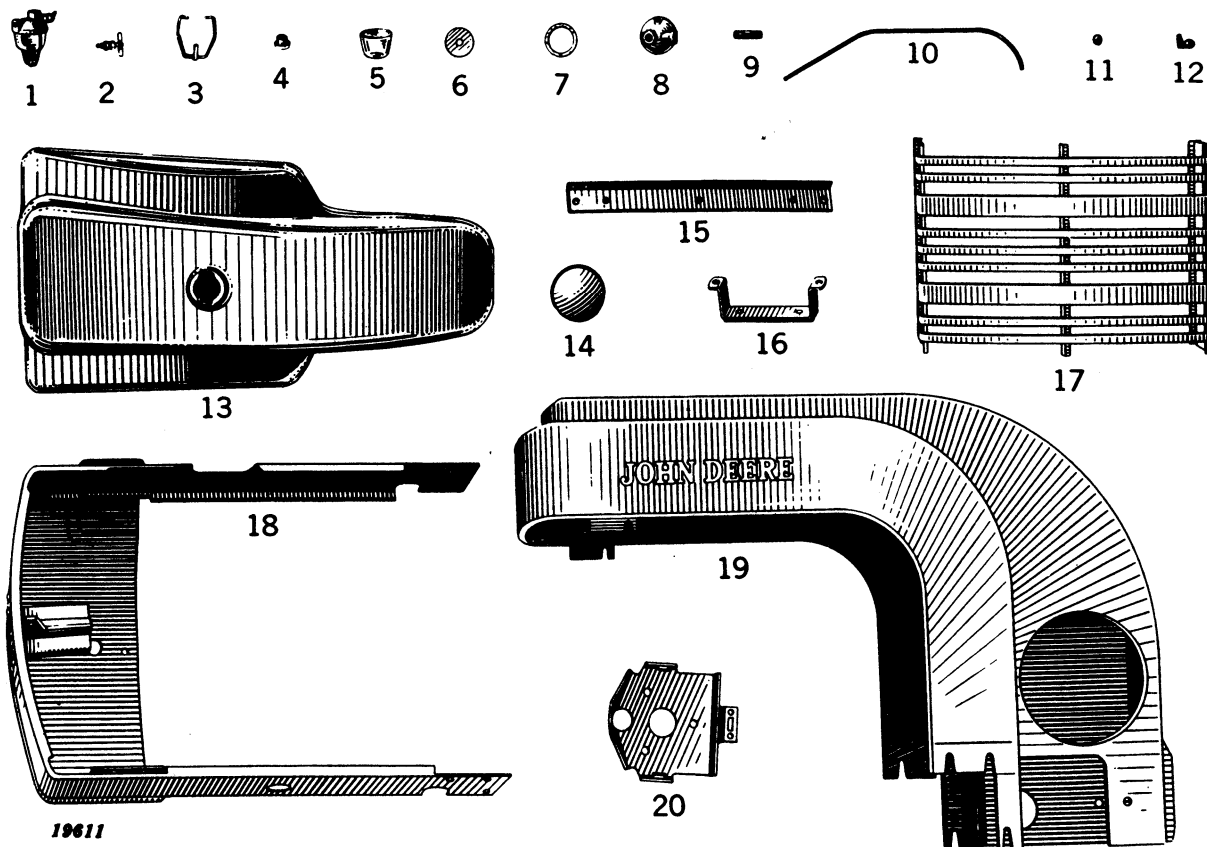

19611

Key	Part No.	Serial No.	Description
1	AL 2087 T	(-)	Filter, Fuel, Complete
2	AL 2117 T	(-)	Valve, Shut-Off, Fuel Filter
3	AL 2118 T	(-)	Wire, Clamp, with Stud, Fuel Filter
4	AL 2119 T	(-)	Nut, Thumb, Assembly, Fuel Filter
5	AL 884 T	(-)	Bowl, Glass, Fuel Filter
6	L 885 T	(-)	Screen, Fuel Filter
7	L 886 T	(-)	Gasket, Fuel Filter
8	L 893 T	(-)	Cover, Fuel Filter
9	29H 483 R	(-)	Nipple, Pipe Fuel Filter to Fuel Tank
10	AL 2757 T	(-)	Line, Fuel, with 2 Ferrules
11	L 587 T	(-)	Ferrule, Fuel Line (2 Used)
12	AL 2730 T	(-)	Elbow Assembly, Fuel Filter
13	AL 2764 T	(-)	Tank, Fuel
14	AL 2275 T	(-)	Cap, Fuel Tank
15	AL 2768 T	(-)	Support, Fuel Tank, with Lining, Front
16	AL 2272 T	(-)	Support, Fuel Tank, with Lining, Rear
17	AL 2268 T	(-)	Grille Assembly, Engine House
18	AL 2267 T	(-)	Base and Shield Assembly, Engine House
19	AL 2902 T	(-)	Top and Sides Assembly, Engine House
20	AL 2763 T	(-)	Support, Engine House, Rear



LIGHTS, SWITCH, BATTERY MOUNTING AND CABLES

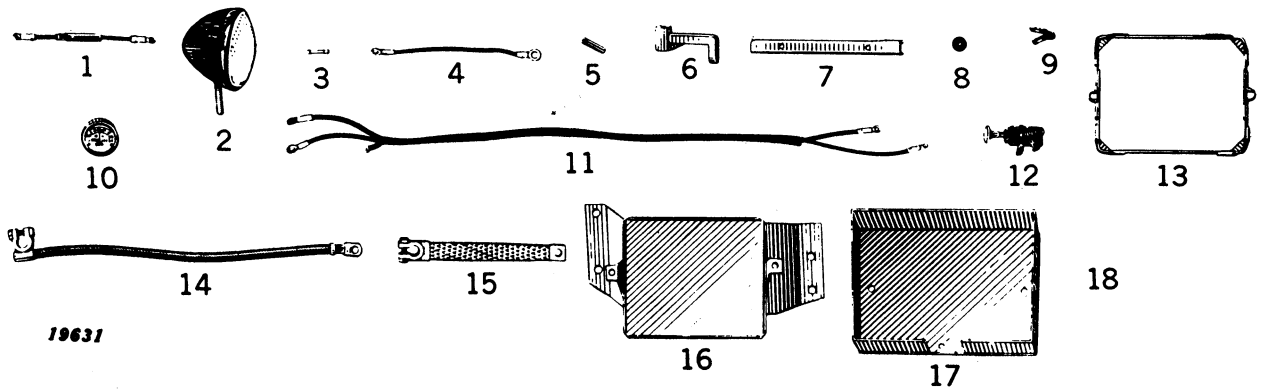

Key	Part No.	Serial No.	Description
1	AL 2793 T	(-)	Lead, Ammeter to Switch, with Fuse
2	AM 3257 T	(-)	Light (2 Used) (Sub. for AL2855T)
3	AL 2919 T	(-)	Fuse
4	AL 2924 T	(-)	Lead, Ammeter to Battery (Lights without Starter)
5	AL 2976 T	(-)	Connector, Light Leads (5 Used)
6	L 4312 T	(-)	Bracket, Headlight (2 Used)
7	L 4343 T	(-)	Channel, Steering Column Support
8	L 4352 T	(-)	Grommet, Rubber (3 Used)
9	L 4353 T	(-)	Bracket, Transmission, Rear Light Lead
10	AF 2749 R	(-)	Ammeter (Sub. for AB2568R)
11	AL 2792 T	(-)	Harness, Wiring, Generator to Ammeter to Switch
12	1995603	(-)	Switch, Light, less Knob
13	AL 2818 T	(-)	Hold-Down, Battery
14	AL 2822 T	(-)	Cable, Battery to Starter
15	AL 2823 T	(-)	Strap, Ground
16	AL 2824 T	(-)	Plate, Battery Mounting
17	AL 2858 T	(-)	Cover, Battery
18	L 4349 T	(-)	Spacer, Battery Cover (2 Used)

Parts listed below are not illustrated.

L 4350 T	(-)	Bolt, Battery Hold-Down (2 Used)
AL 2795 T	(-)	Lead, Headlight Switch (2 Used)
AL 2798 T	(-)	Lead, Taillight to Switch
AL 2975 T	(-)	Taillight Complete
L 1203 T	(-)	Screw, Steering Column Support Channel
L 1211 T	(-)	Washer, Lock, Switch Attaching
L 1198 T	(-)	Washer, Battery Hold-Down Bolts (2 Used)
14H 466 T	(-)	Nut, Hex., Light Switch to Panel
F 690 R	(-)	Knob, Light Switch



TRACTOR—MODEL "LI"

AL2908T MAGNETO AND CABLES

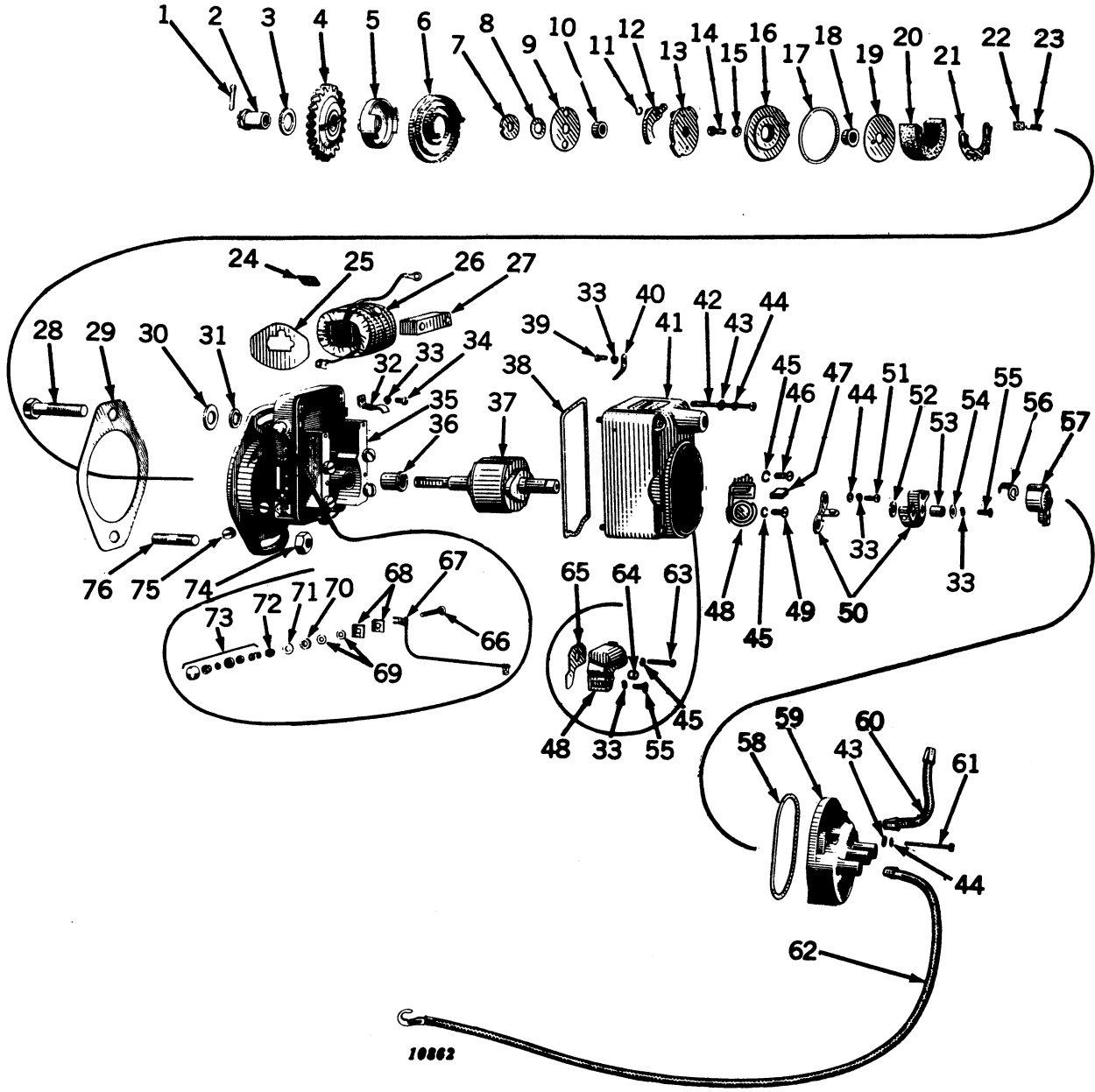

Key	John Deere Part No.	Outside Manufacturer's Part No.	Serial No.	Description
1	11H 20 T		(-)	Pin, Cotter, Impulse Lock Nut, 3/32" x 3/4"
2		2076	(-)	Nut, Lock, Impulse
3		4140	(-)	Washer, Gear Spacing
4	AL 4380 T		(-)	Gear, Magneto Drive
5		2040	(-)	Cup, Drive
6		15-186*	(-)	Spring, Drive
7		16-583*	(-)	Washer, Drive Cap Spacing, Brass
		(IVA 583*	(-)	Washer, Spacing, Steel
8		M 42 XA	(-)	Washer, Drive Cup
9		2288*	(-)	Retainer, Drive Spring
10		2122*	(-)	Spacer, Driven Flange
11		A 243 A	(-)	Ring, Snap (2 Used)
12		A 179 X	(-)	Pawl, Impulse (2 Used)
13		X 3194	(-)	Driven Flange Group with Pawls
14	21H 988 R*		(-)	Screw, Impulse Stop, No. 12 x 1/2" (4 Used)
15	H 666 R*		(-)	Washer, Lock (4 Used)



AL2908T MAGNETO AND CABLES—Continued

Key	John Deere Part No.	Outside Manufacturer's Part No.	Serial No.	Description
16		(X 2719* A 33 X*	(-)	Impulse Stop Group
17		2496*	(-)	Seal, Oil
18		2121*	(-)	Gasket, Impulse Stop
19		X 2747	(-)	Spacer, Impulse
20		1379*	(-)	Disk, Oiling
21		2505*	(-)	Pad, Main Oil, Felt
22		1152*	(-)	Plate, Spring, Oil Pad
23		1153*	(-)	Scraper, Oil
24		3497 A	(-)	Spring, Oil Scraper
25		1760*	(-)	Wedge, Coil (2 Used)
26		X 2766*	(-)	Plate, Coil Protecting (2 Used)
27		X 2706*	(-)	Coil
28	19H 278 T		(-)	Core, Coil
29	L 348 T		(-)	Screw, Cap, 3/8" N.F. x 3"
30	L 1148 T		(-)	Gasket, Magneto Attaching
31	(12H 11 R AA 3403 R		(-)	Washer, Magneto Attaching, 3/8" (2 Used)
32		2503*	(-)	Washer, Lock, Magneto Attaching, 3/8" (2 Used)
33	A 766 R*		(-)	Washer, Lock, Magneto Attaching (Box of 50)
34	21H 973 R*		(-)	Clamp, Coil Core (2 Used)
35		X 3872	(-)	Washer, Lock, No. 8 (6 Used)
36		2495	(-)	Screw, Coil Core Clamp, No. 8 x 3/8" (2 Used)
37		X 2919	(-)	Main Housing Group
38		2504*	(-)	Bushing, Rotor (2 Used)
39		1404*	(-)	Rotor (Armature)
40		1397*	(-)	Gasket, Cover
41		X 2798*	(-)	Screw, Secondary Interlead Contact
42		2538*	(-)	Interlead Coil Contact
43		1118*	(-)	Cover, with Breaker Plate Assembly and Screws
44		IXA 256*	(-)	Screw, Cover (4 Used)
45	A 765 R*		(-)	Washer, Leather (6 Used)
46	21H 962 R*		(-)	Washer (7 Used)
47		5446	(-)	Washer, Lock, Condenser Screw, No. 6 (3 Used)
48		X 1413*	(-)	Screw, Condenser, No. 6 x 1/4" (Used with Metal Case)
49	21H 964 R*		(-)	Wiper, Cam, Felt (Used with Metal Case Condenser)
50		X 3343*	(-)	Condenser
51	21H 971 R*		(-)	Screw, Mach., Plated, Breaker Spring Clamp, No. 6 x 1/2" (Used with Metal Case Condenser)
52		(1197* 1197 T* 1418*	(-)	Point, Breaker, Assembly
53			(-)	Screw, Fixed Contact, No. 8 x 5/16"
54	B 1085 R*		(-)	Washer, Spacing, Breaker Arm
55		16-738*	(-)	Shim, Spacing, Breaker Arm (If Needed)
56		16-480*	(-)	Spacer, Breaker Arm
57		16-X 477 B*	(-)	Washer, Breaker Arm Clamp
58		2497*	(-)	Screw, Breaker Point and Breaker Spring Clamp (2 Used)
59		X 4603	(-)	Spring, Lock Arm
60		X 2725	(-)	Arm with Spring (Rotor)
61		2537*	(-)	Gasket
62	AL 2923 T		(-)	Cap with Screws
63	21H 966 R*		(-)	Interlead, Secondary
64		1194*	(-)	Screw, Cap (2 Used)
65		1533*	(-)	Cable, Spark Plug (2 Used)
66		3538*	(-)	Screw, Condenser, No. 6 x 3/4" (2 Used)
67		X 2721 A	(-)	Wiper, Cam, Felt, (Used with Bakelite Condenser)
68		3539*	(-)	Gasket, Condenser
69		M 34 X	(-)	Stud, Ground
70		M 35 X	(-)	Lead, Stop Button
71		M 33 X	(-)	Washer, Insulating, Inner (2 Used)
72		M 72 X	(-)	Washer, Ground Stud (2 used)
73		A 140	(-)	Washer, Insulating, Ground Stud (2 Used)
74	14H 383 R*		(-)	Washer, Brass, Outside, Ground Stud
75	B 1107 R*		(-)	Nut, Ground Stud
76	L 872 T		(-)	Stop Button Group
..		(-)	Nut, Hex., 3/8" N.F., (2 Used)
			(-)	Plug, Oil (2 Used)
			(-)	Stud, Magneto Attaching
			(-)	Magneto Complete (Order AL20274T)

*Parts furnished to John Deere Branch Houses by John Deere Waterloo Tractor Works of Waterloo, Iowa.



TRACTOR—MODEL "LI"

AL20274T MAGNETO AND CABLES

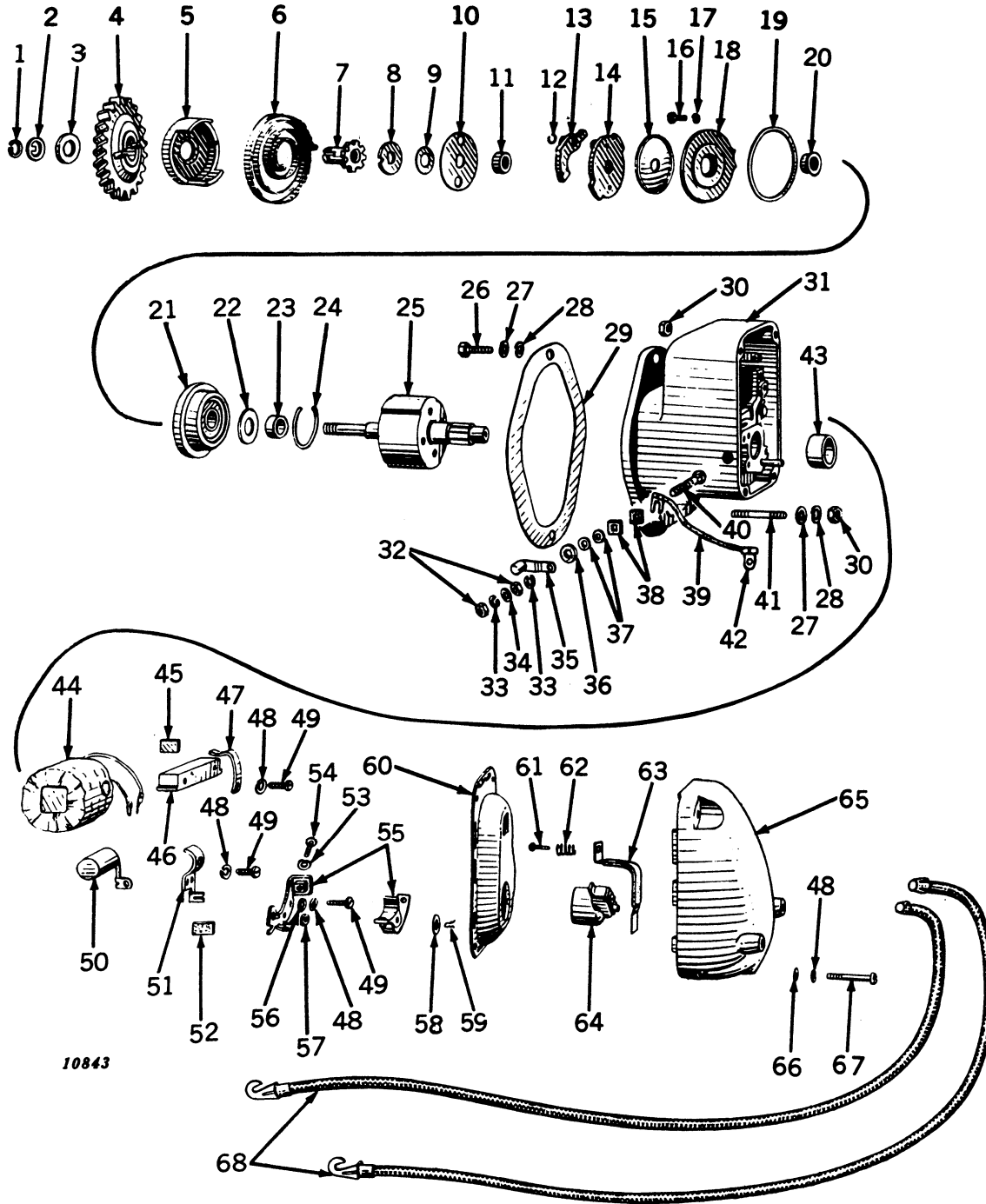

10843

Key	John Deere Part No.	Outside Manufacturer's Part No.	Serial No.	Description
1		6424	(-)	Ring, Snap, Drive Gear
2		6425	(-)	Washer, Gear
3		4140	(-)	Washer, Spacing, Drive Gear
4	AL 4380 T		(-)	Gear, Magneto Drive
5		2040	(-)	Cup, Drive
6		15-186*	(-)	Spring, Impulse Drive
7		K 6445	(-)	Nut, Impulse Lock Replacement Kit (Includes Lock Nut, Retainer Ring and Thrust Washer)

AL20274T MAGNETO AND CABLES

Key	John Deere Part No.	Outside Manufacturer's Part No.	Serial No.	Description
8		IVA 583*	(-)	Washer, Drive Cup Spacing (Steel)
9		M 42 XA*	(-)	Washer, Drive Cup Retainer, Drive Spring
10		2288*	(-)	Retainer, Drive Spring
11		2122*	(-)	Spacer, Driven Flange
12		A 243 X*	(-)	Ring, Snap, Tripping Arm (2 Used)
13		A 179 X*	(-)	Arm, Tripping Impulse Pawl (2 Used)
14		X 2286	(-)	Flange Group, Driven, with Pawls
15		6204*	(-)	Slinger, Oil
16	21H 988 R*		(-)	Screw, Impulse Stop Plate, No. 12-2 x 1/2" (4 Used)
17	H 666 R*		(-)	Washer, Lock, Impulse Stop Plate Screw, No. 12 (4 Used)
18		(X 5549*	(-)	Stop Group, Impulse
		6199*	(-)	Seal, Oil
19		5519*	(-)	Gasket, Impulse Stop
20		5518*	(-)	Spacer, Impulse
21		X 5521*	(-)	Bearing, Cage Group
22		5926*	(-)	Shield, Ball Bearing
23		5520*	(-)	Spacer, Ball Bearing
24		5516*	(-)	Ring, Retaining, Ball Bearing Shield
25		Y 5761	(-)	Rotor
26	19H 278 T		(-)	Screw, Cap, 3/8"-2 x 3"
27	L 1148 T		(-)	Washer, Magneto Attaching (2 Used)
28	(12H 11 R		(-)	Washer, Lock, Magneto to Cylinder Block, 3/8" (2 Used)
	AA 3402 R*		(-)	Washer, Lock, Magneto to Cylinder Block, 3/8" (Box of 50)
29	L 348 T		(-)	Gasket, Magneto to Cylinder Block
30	14H 383 R*		(-)	Nut, Hex., Magneto to Cylinder Block, 3/8" (2 Used)
31		X 6501	(-)	Housing Assembly
32	14H 605 R*		(-)	Nut, Hex., Ground Stud, No. 8 (2 Used)
33	A 766 R*		(-)	Washer, Lock, Ground Stud, No. 8 (2 Used)
34		IXA 256*	(-)	Washer, Ground Stud
35		X 5632	(-)	Button, Stop, Group
36		M 35 X	(-)	Washer, Ground Stud, Insulating, Outer
37		M 34 X	(-)	Bushing, Ground Stud, Insulating (2 Used)
38		3539*	(-)	Washer, Ground Stud, Insulating, Inner (2 Used)
39		X 5757*	(-)	Lead, Ground Connection
40		3945*	(-)	Stud, Ground
41	L 872 T		(-)	Stud, Magneto to Cylinder Block
42		1814*	(-)	Terminal, Ground Leak (Breaker Point End)
43		5610*	(-)	Bushing, Rotor
44		X 5700*	(-)	Coil Group
45		10383*	(-)	Wedge, Coil
46		X 5524*	(-)	Core Group, Coil
47		5633*	(-)	Clamp, Coil Core
48	12H 35 R*		(-)	Washer, Lock, Coil Core Clamp, Fixed Contact, Condenser Clamp and Magneto Cover Screws, No. 8 (10 Used)
49	21H 973 R		(-)	Screw, Coil Core Clamp, Fixed Contact and Condenser Clamp, No. 8 (6 Used)
50		X 5614*	(-)	Condenser Group
51		5532*	(-)	Clamp, Condenser, without Felt Cam Wiper
52		5077*	(-)	Wiper, Felt Cam
53	A 765 R*		(-)	Washer, Lock, Breaker Spring Screw, No. 6
54	21H 964 R*		(-)	Screw, Breaker Spring, No. 6-2 x 1/2"
55		(X 5996*	(-)	Point Assembly, Breaker
		6468*	(-)	Felt, Breaker Arm Cam Wiper
56	B 1085 R*		(-)	Washer, Fixed Breaker Arm Clamp (2 Used)
57		10407*	(-)	Washer, Spacing (Under Breaker Arm)
58		3219*	(-)	Washer, Breaker Arm Pivot
59		4210*	(-)	Lock, Breaker Arm
60		5644*	(-)	Gasket, Magneto Cover
61		5536*	(-)	Screw, Secondary Interlead
62		5620*	(-)	Spring, Coil Contact
63		X 6000*	(-)	Interlead, Secondary
64		X 5531	(-)	Arm, Distributor
65		X 5769	(-)	Cover, Magneto (Complete with Secondary Interlead and Cover Attaching Hardware)
66		IXA 256*	(-)	Washer, Cover Screw (4 Used)
67		5622*	(-)	Screw, Magneto Cover, with Washer (4 Used)
68	AL 2923 T		(-)	Cable, Spark Plug (2 Used)
..	AL 20274 T		(-)	Magneto, Complete

*Parts furnished to John Deere Branch Houses by John Deere Waterloo Tractor Works of Waterloo, Iowa.



TRACTOR—MODEL "LI"

GENERATOR

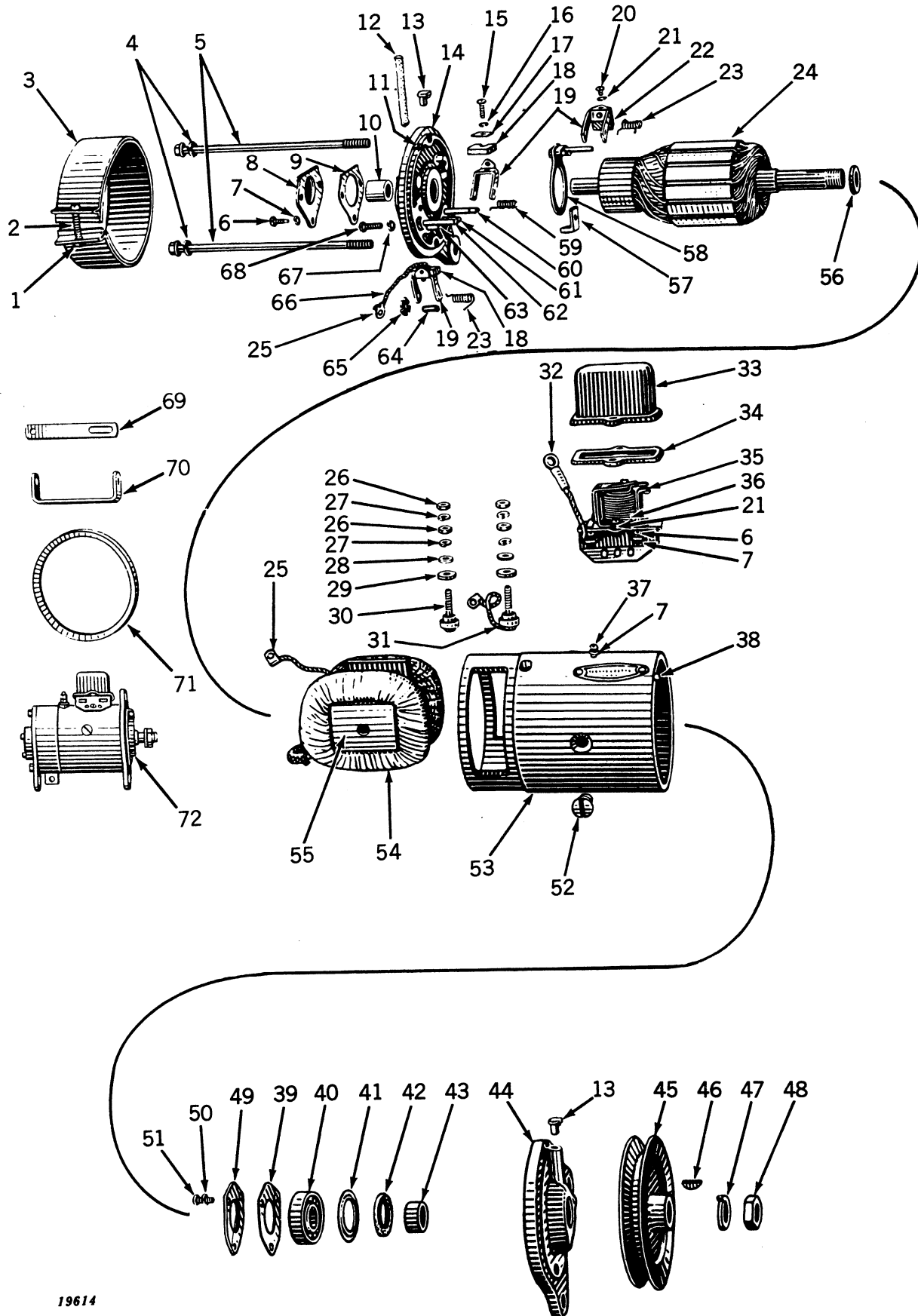

19614



GENERATOR

Key	John Deere Part No.	Outside Manufacturer's Part No.	Serial No.	Description
1	14H 631 R*		-	Nut
2	21H 985 R*		-	Screw
3		1872638*	-	Band, Cover
4	12H 68 R*		-	Washer, Lock (2 Used)
5		815018*	-	Bolt (2 Used)
6		1881998*	-	Screw (5 Used)
7	A 3008 R*		-	Washer, Lock (7 Used)
8		820524*	-	Plate, End Cover
9		817220*	-	Gasket, End Cover Plate
10	AA 3497 R*		-	Bushing
11		809062*	-	Pin, Dowel
12		804076*	-	Wick, Oil (Felt)
13	E 2302 RT		-	Oiler (2 Used)
14		817216*	-	Frame, Commutator End, with Pins
		1911097*	-	Plug, Oil Hole
15		451608*	-	Screw (3 Used)
16	A 765 R*		-	Washer, Lock (3 Used)
17		809551*	-	Washer, Brush (Rectangular) (3 Used)
18		1836664*	-	Brush, Main (2 Used)
19		809642*	-	Holder, Brush (3 Used)
20	21H 961 R*		-	Screw (2 Used)
21		802730	-	Washer, Lock (4 Used)
22		1880225*	-	Brush, Third
23		809644	-	Spring, Third and Ground Brush (2 Used)
24		1841027*	-	Armature
25		200182*	-	Terminal, Brush Lead (2 Used)
26	14H 608 R*		-	Nut (4 Used)
27	A 3011 R*		-	Washer, Lock (4 Used)
28	A 3031 R*		-	Washer, Plain (2 Used)
29		1858753*	-	Washer, Insulating (2 Used)
30		1858749*	-	Stud Assembly, Terminal (2 Used)
31		1858754*	-	Stud, Terminal, and Lead Assembly
32		1872661*	-	Lead, "A" Terminal to Relay
33		1881250*	-	Cover, Relay (Screw Fastened Type)
34		1881251	-	Gasket, Screw Type Cover
35		1116809*	-	Relay Assembly with Cover
36	21H 238 R*		-	Screw (2 Used)
37	21H 971 R*		-	Screw (2 Used)
38		809593*	-	Pin, Dowel
39		1912008*	-	Gasket, Retainer Plate
40	JD 7180 R*		-	Bearing, Ball
41		819104*	-	Plate, Felt Retainer
42		809961*	-	Washer, Felt
43		817224*	-	Collar, Outside
44		817223*	-	Frame, Drive End
45	AL 4198 T		-	Pulley, Generator
46	26H 72 R*		-	Key, Woodruff
47		804000*	-	Washer, Lock
48		806915	-	Nut
49		1911263*	-	Plate, Bearing Retainer
50	A 3009 R*		-	Washer, Lock (3 Used)
51		1904829*	-	Screw (3 Used)
52		1843646*	-	Screw (2 Used)
53		1867168*	-	Frame, Main
54		1902102*	-	Coil, Field
55		816331*	-	Shoe, Pole (2 Used)
56		809945*	-	Washer, Inside Spacing
57		817532*	-	Clamp, Third Brush Plate
58		809698*	-	Plate, Third Brush
59		809658*	-	Spring, Main Brush
60		812016*	-	Pin, Main Brush Holder Hinge (Insulated)
61		812015*	-	Pin, Main Brush Holder Stop (Insulated)
62		817313*	-	Pin, Ground Brush Holder Hinge
63		817314*	-	Pin, Ground Brush Holder Stop
64		809614*	-	Pin, Third Brush Plate Spring Washer
65		809824*	-	Washer, Third Brush Plate Spring
66		809688	-	Lead, Ground Brush
67	A 767 R*		-	Washer, Lock
68	21H 983 R*		-	Screw, Third Brush Plate Clamp
69	L 4199 T		-	Link, Adjusting, Generator
70	L 4200 T		-	Bracket, Generator
71	L 4201 T		-	Belt, Generator
72	AB 1204 R*		-	Generator Less Pulley

*Parts provided to John Deere Branch Houses by John Deere Waterloo Tractor Works of Waterloo, Iowa.



TRACTOR—MODEL "LI"

STARTING MOTOR

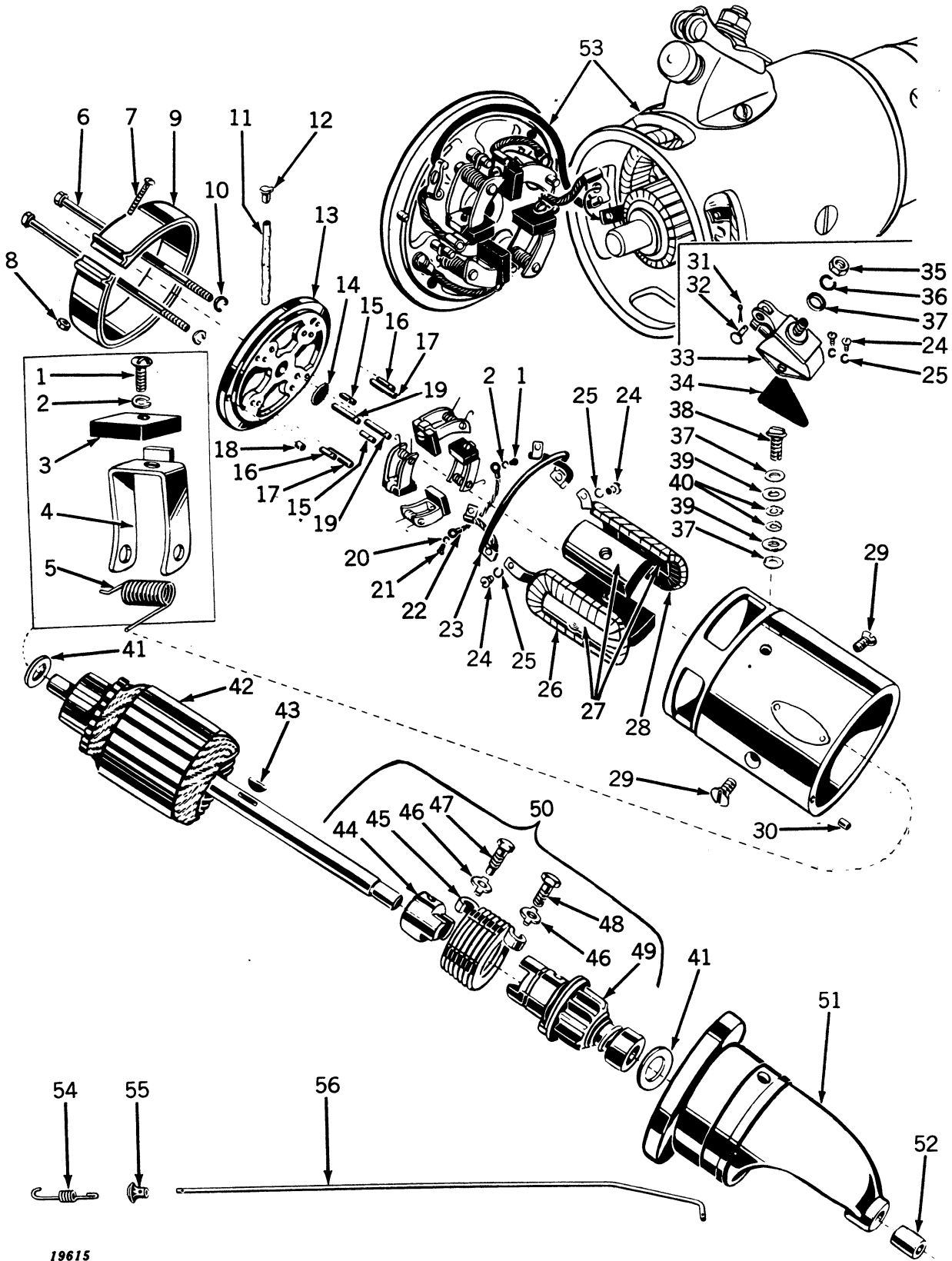

19615



		Outside		STARTING MOTOR	
Key	John Deere Part No.	Manufacturer's Part No.	Serial No.	Description	
1	21H 964 R*		(-)	Screw, Brush Attaching, No. 6-32 NC2 x 1/2", Plated, (4 Used)	
2	A 765 R*		(-)	Washer, Lock, Brush Screw (4 Used)	
3		811553*	(-)	Brush (4 Used)	
4		810226*	(-)	Holder, Brush (4 Used)	
5		813521*	(-)	Spring, Brush (4 Used)	
6		809053	(-)	Bolt, Through (2 Used)	
7	21H 986 R*		(-)	Screw, Cover Band, No. 10-32 NF2 x 1-1/4" Round Hd., Plated	
8	14H 631 R*		(-)	Nut, Cover Band Screw, No. 10-32 NF2 Mach. Screw Nut, Plated	
9		1886923*	(-)	Band, Cover	
10	12H 9 R		(-)	Washer, Lock, Through Bolt, 1/4" SAE Medium (2 Used)	
11		802691*	(-)	Wick, Oiler, Commutator End	
12		114998*	(-)	Oiler, Commutator End	
13		1873774	(-)	Frame, Commutator End with Pins and Oiler	
14		1865182*	(-)	Plug, Expansion, Commutator End	
15		812015*	(-)	Pin and Insulator, Brush Holder, Stop (2 Used)	
16		817314*	(-)	Pin, Brush Holder, Stop (2 Used)	
17		817313*	(-)	Pin, Brush Holder, Hinge (2 Used)	
18		809062*	(-)	Pin, Dowel, Commutator End Frame to Body	
19		812016*	(-)	Pin, and Insulator, Brush Holder, Hinge (2 Used)	
20	A 766 R*		(-)	Washer, Lock, Brush Ground Lead Screw (2 Used)	
21	21H 969 R*		(-)	Screw, Brush Ground Lead, No. 8-32 NC2 x 1/4", Plated, (2 Used)	
22		813554*	(-)	Lead, Brush Ground (2 Used)	
23		819362*	(-)	Lead, Brush Jumper	
24	21H 395 R*		(-)	Screw, Brush Lead to Field Coil and Switch Mounting, No. 10-32 NF2 x 1/4" Rd. Hd. Mach. Screw, (4 Used)	
25	A 767 R*		(-)	Washer, Lock, Brush Lead to Field Coil Screw and Switch Attaching Screw, No. 10 SAE Medium, (4 Used)	
26		812406	(-)	Coil, Field, R.H. (Distributor Side of Tractor)	
27		810601*	(-)	Shoe, Pole (4 Used)	
28		812407	(-)	Coil, Field, L.H. (Carburetor Side of Tractor)	
29		1881869*	(-)	Screw, Pole Shoe (4 Used)	
30		809593*	(-)	Pin, Dowel, Drive Body to Main Body	
31	11H 3 R*		(-)	Pin, Cotter, Switch Pin, 1/16" x 1/2"	
32		1880254*	(-)	Pin, Switch	
33		1882323	(-)	Switch, Complete with Hardware	
34		816911 R*	(-)	Insulation, Switch Side (2 Used)	
35	14H 732 R*		(-)	Nut, Hex. Jam-Switch Terminal, Stud, 3/8"-16 NC2, Plated (2 Used)	
36	12H 11 R		(-)	Washer, Lock, Switch Terminal, 3/8" SAE Medium	
37	24H 156 R*		(-)	Washer, Switch Terminal and Switch Terminal Stud (3 Used)	
38		821524	(-)	Stud, Switch Terminal	
39		1861076*	(-)	Washer, Switch and Terminal Stud, Insulating (Large) (2 Used)	
40		1904669*	(-)	Washer, Switch Terminal Stud, Insulating, (Small) (2 Used)	
41		833602*	(-)	Washer, Commutator End Spacer and Drive End Spacer (2 Used)	
42		1872505	(-)	Armature	
43	26H 19 R*		(-)	Key, Woodruff, Drive End, 5/32" x 5/8"	
44	A 2784 R*		(-)	Head Drive	
45		1860639	(-)	Spring, Drive	
46		805057*	(-)	Washer, Lock, Head Spring Screw and Shaft Spring Screw (2 Used)	
47		1850811*	(-)	Screw, Head Spring	
48		1850810*	(-)	Screw, Shaft Spring	
49		1855629	(-)	Gear and Shaft with Service Sleeve	
50		1868804	(-)	Drive Assembly	
51		1882324	(-)	Housing, Drive with Bushing	
52		810620*	(-)	Bushing, Drive Housing	
53	AL 2723 T		(-)	Motor, Starting	
54	L 4246 T		(-)	Spring, Starter Rod	
55	L 4281 T		(-)	Knob, Starter Rod	
56	L 4287 T		(-)	Rod, Starter	
Parts listed below are not illustrated.					
		1849782*	(-)	Sleeve, Bendix	
	A 2789 R*		(-)	Ring, Snap, Sleeve, Retaining	
	L 4247 T		(-)	Lever, Starter, Switch	
	AL 2794 T		(-)	Lead, Starter to Ammeter	

*Parts provided to John Deere Branch Houses by John Deere Waterloo Tractor Works of Waterloo, Iowa.

TRACTOR—MODEL "LI"
SEAT, FRAME, AND FENDERS

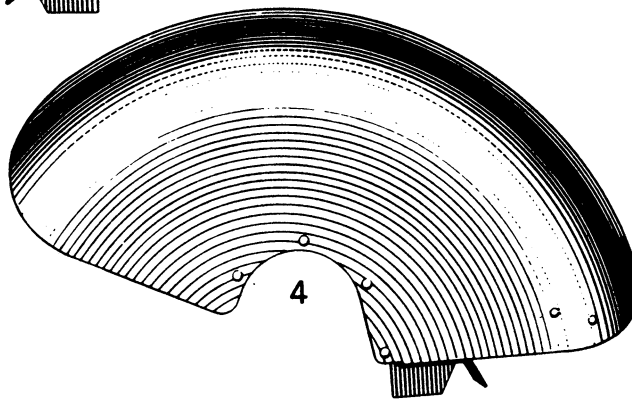
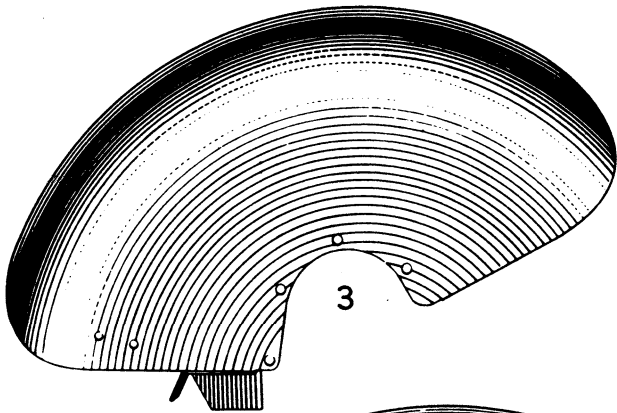
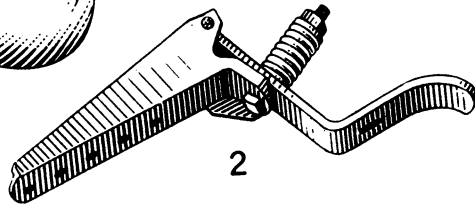
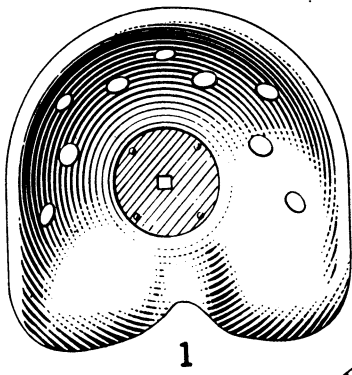

5



6



7

19616

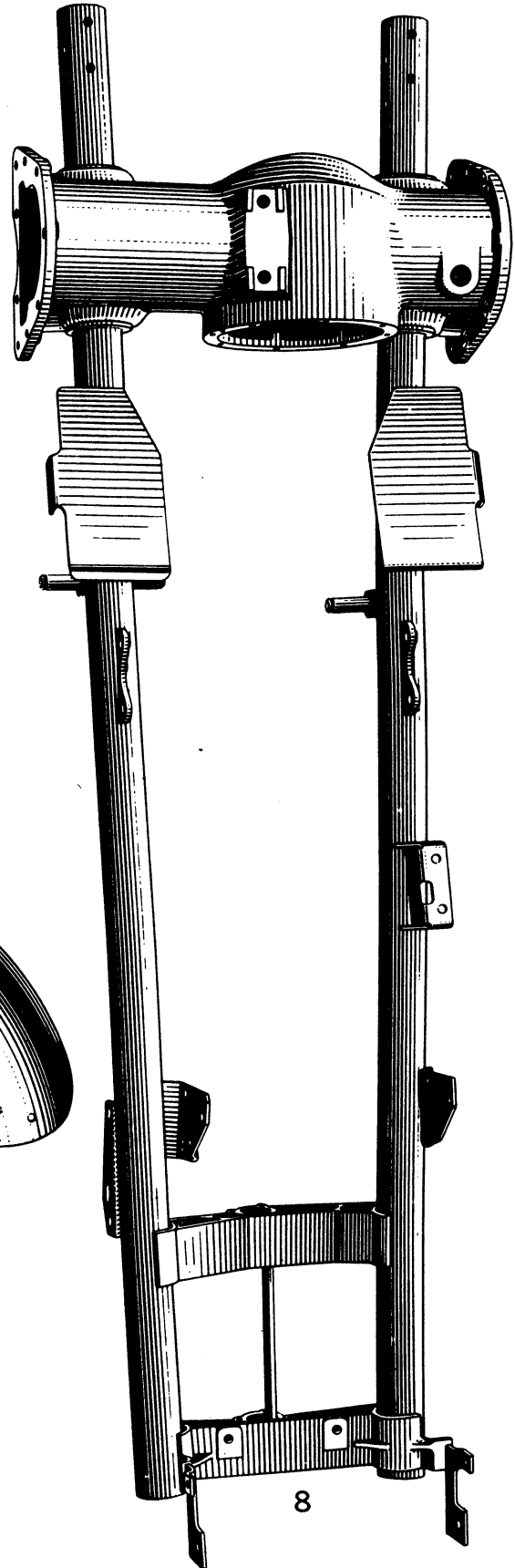

SEAT, FRAME, AND FENDERS

Key	Part No.	Serial No.	Description
1	AD 1606 R	(-)	Seat
2	AL 2458 T	(-)	Bracket, Seat, with Spring, Complete
3	AL 2203 T	(-)	Fender, R.H.
4	AL 2464 T	(-)	Fender, L.H.
5	L 547 T	(-)	Spring, Seat
6	L 552 T	(-)	Holder, Seat Bracket Spring (2 Used)
7	L 682 T	(-)	Stud, Seat Bracket (2 Used)
8	AL 2843 T	(-)	Frame, Tractor, Complete

Parts listed below are not illustrated.

L	1121 T	(-)	Nut, Square, Seat Spring to Bracket
L	1149 T	(-)	Washer, Plain, Seat Bracket Bolt
3H	675 T	(-)	Bolt, Carriage, Seat to Seat Bracket, 5/8" x 1-3/4"
8H	1566 T	(-)	Bolt, Machine, Seat Spring, 3/4" x 6-1/2"
AL	2412 T	(-)	Tools, Bag
JD	7754	(-)	Gun, Hydraulic grease



TRACTOR—MODEL "LI"

PROPELLER SHAFT, GUARD, AND ASSOCIATED PARTS

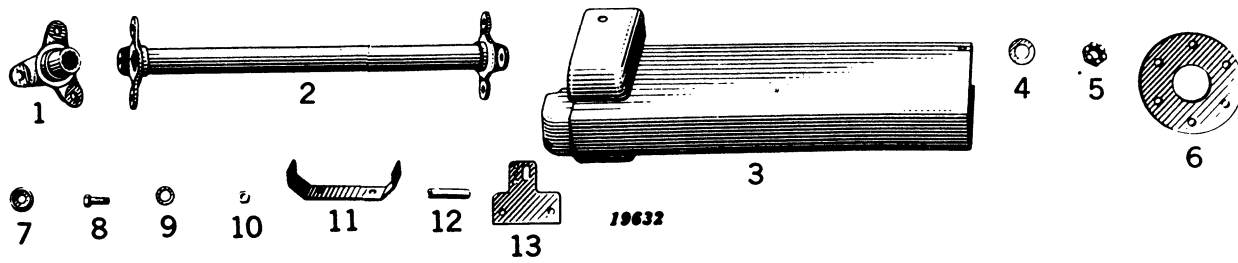

Key	Part No.	Serial No.	Description
1	AL 2209 T	(-)	Spider, Outer (2 Used)
2	AL 2614 T	(-)	Shaft, Propeller, with End Spiders
3	AL 2866 T	(-)	Guard, Propeller Shaft
4	L 273 T	(-)	Washer, Spider to Shaft (2 Used)
5	L 366 T	(-)	Nut, Hex., Slotted, Spider to Shaft (2 Used)
6	L 373 T	(-)	Disk, Fabrics (2 Used)
7	L 374 T	(-)	Washer, with Bead (12 Used)
8	L 375 T	(-)	Screw, Cap, Fabric Disk to Spiders (12 Used)
9	24H 379 T	(-)	Washer (12 Used)
10	14H 518 T	(-)	Nut, Hex., Slotted, Fabric Disk to Spider Screws (12 Used)
11	L 4054 T	(-)	Support, Propeller Shaft Guard, Rear
12	L 4058 T	(-)	Spacer, Propeller Shaft Guard (2 Used)
13	L 4248 T	(-)	Plate, Ratchet, Governor Control Rod

(Parts listed below are not illustrated.)

19H	190 T	(-)	Screw, Cap, Spacer to Propeller Shaft Guard, 5/16" x 7" (2 Used)
L	602 T	(-)	Spring, Governor Control Rod Ratchet Plate



CLUTCH HOUSING ASSEMBLY

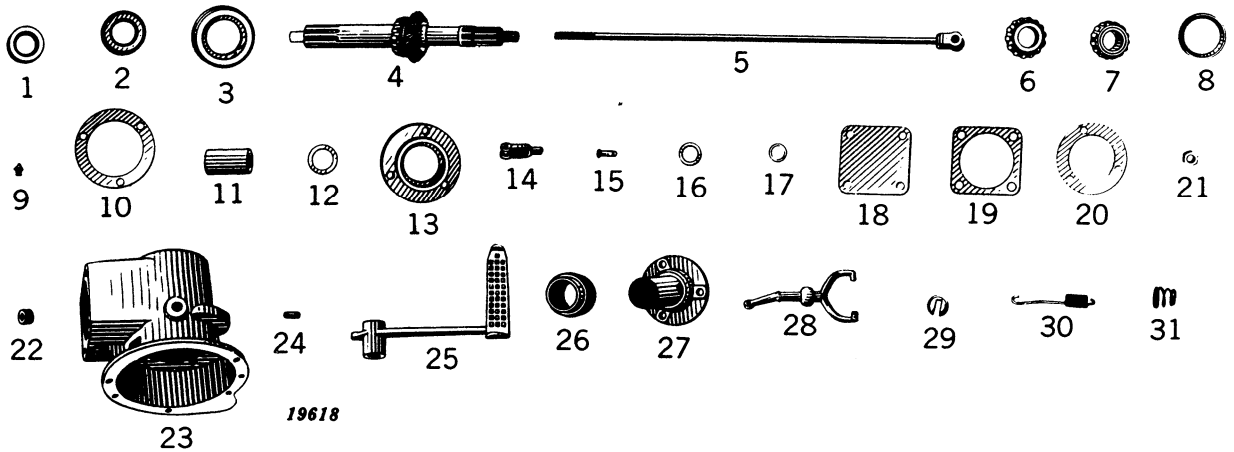

19618

Key	Part No.	Serial No.	Description
1	AL 2094 T	(-)	Seal, Oil, Front
2	AL 2095 T	(-)	Seal, Oil, Rear
3	AL 2116 T	(-)	Bearing, Clutch Throw-Out
4	AL 2350 T	(-)	Shaft, Splined, with Bearing Cone and Spiral Bevel gear
5	AL 2659 T	(-)	Rod, Clutch Throw-Out
6	JD 7212 H	(-)	Cone, Bearing, Splined Shaft, Rear
7	JD 7243 T	(-)	Cone, Bearing, Splined Shaft, Front
8	JD 7262 R	(-)	Cup, Bearing, Splined Shaft, Front and Rear (2 Used)
9	JD 7759	(-)	Fitting, Grease, Clutch Pedal, Straight
10	L 113 T	(-)	Shim, Rear Bearing Retainer to Shaft Housing, .010"
	L 114 T	(-)	Shim, Rear Bearing Retainer to Shaft Housing, .005"
	L 115 T	(-)	Shim, Rear Bearing Retainer to Shaft Housing, .002"
11	AL 116 T	(-)	Spacer; Splined Shaft
12	L 117 T	(-)	Washer, Plain, Spacer
13	AL 20293 T	(-)	Retainer, Bearing, Clutch Shaft, Rear
14	L 299 T	(-)	Yoke, Adjusting, Clutch Throw-Out Rod
15	L 307 T	(-)	Pin, Yoke, Clutch Throw-Out Rod Yoke (2 Used)
16	L 308 T	(-)	Washer, Pedal Shaft
17	L 357 T	(-)	Ring, Snap, Pedal Shaft
18	L 535 T	(-)	Cover, Clutch Shaft Housing
19	L 539 T	(-)	Gasket, Clutch Shaft Housing Cover
20	L 542 T	(-)	Shim, Carrier Sleeve to Shaft Housing, .002"
	L 543 T	(-)	Shim, Carrier Sleeve to Shaft Housing, .005"
	L 544 T	(-)	Shim, Carrier Sleeve to Shaft Housing, .010"
21	14H 463 T	(-)	Nut, Hex., Jam, Throw-Out Rod Yoke
22	15H 255 R	(-)	Plug, Pipe, Oil Drain and Filler (2 Used)
23	AL 4123 T	(-)	Housing, Clutch Shaft
24	L 4126 T	(-)	Pin, Dowel, Clutch Shaft Housing to Cylinder Block (2 Used)
25	AL 4144 T	(-)	Pedal, Clutch
26	AL 4145 T	(-)	Carrier, Throw-Out Bearing
27	AL 4150 T	(-)	Sleeve, Throw-Out Bearing Carrier
28	AL 4182 T	(-)	Fork, Clutch Throw-Out
29	L 4186 T	(-)	Retainer, Clutch Fork Spring
30	L 4223 T	(-)	Spring, Clutch Pedal
31	L 4230 T	(-)	Spring, Clutch Fork



TRANSMISSION-DIFFERENTIAL ASSEMBLY

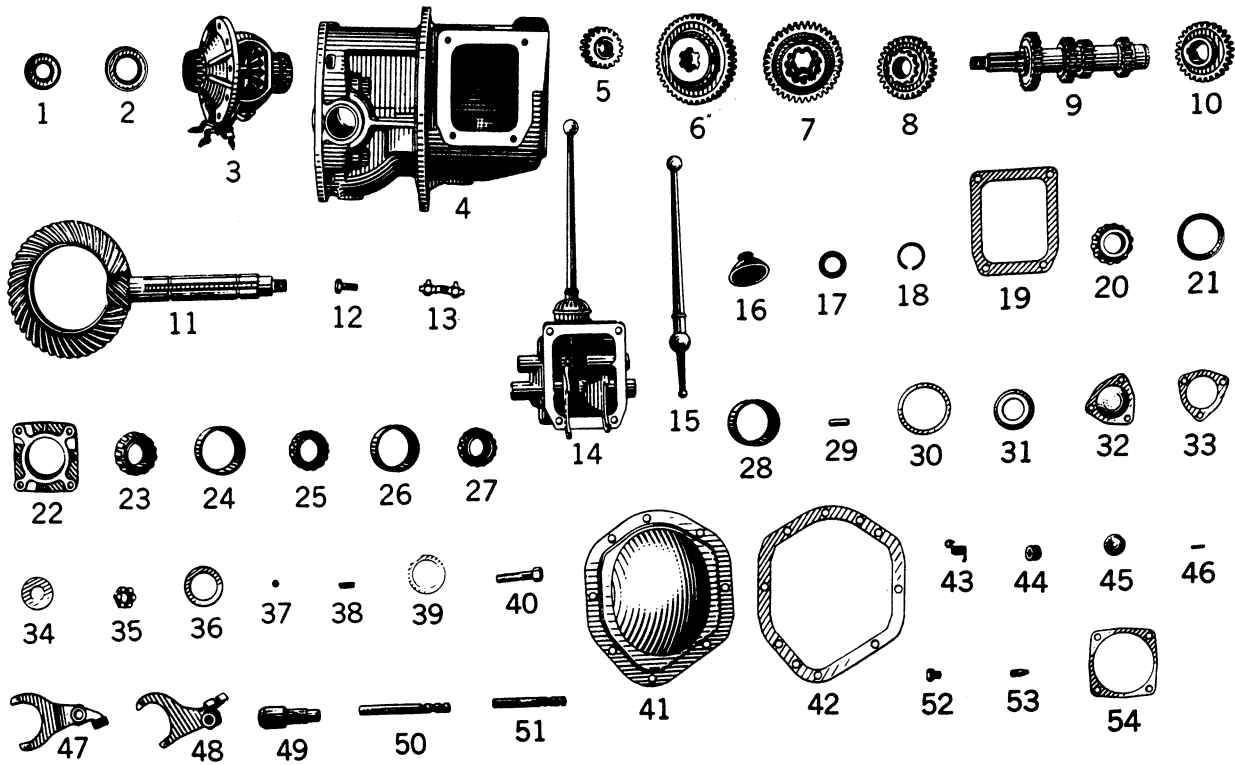

19619



TRANSMISSION-DIFFERENTIAL ASSEMBLY

Key	Part No.	Serial No.	Description
1	AL 2122 T	(-)	Seal, Oil, Differential (2 Used)
2	AL 2123 T	(-)	Gear, Reverse Idler, with Bushing
3	AL 2159 T	(-)	Differential Assembly with Bearing Cover, Shims and Cap Screw Locks, less Ring Gear
4	AL 2601 T	(-)	Case, Transmission and Differential with Differential Bearing Caps
5	AL 2603 T	(-)	Gear, Reverse Idler, with Bushing
6	AL 4004 T	(-)	Gear, First and Reverse Speed Driven on Lower Shaft, 41 Teeth
7	AL 4228 T	(-)	Gear, Second Speed Driven on Lower Shaft, 37 Teeth
8	AL 4006 T	(-)	Gear, Third Speed Driven on Lower Shaft, 28 Teeth
9	AL 2715 T	(-)	Shaft, Upper, Complete, with Four Gears
10	AL 4007 T	(-)	Gear, Third Speed Drive on Upper Shaft, 27 Teeth
11	AL 2845 T	(-)	Gear, Ring, and Pinion Set with Cap Screw Locks
12	L 495 T	(-)	Screw, Cap, Ring Gear to Differential Assembly (10 Used)
13	L 496 T	(-)	Lock, Ring Gear Cap Screws (5 Used)
14	AL 2605 T	(-)	Cover, Transmission Assembly with Shift Lever
15	L 4021 T	(-)	Lever, Shift
16	AL 4022 T	(-)	Grommet, Rubber, Shift Lever
17	L 4027 T	(-)	Bearing, Shift Lever
18	L 4035 T	(-)	Ring, Snap, Shift Lever
19	L 4026 T	(-)	Gasket, Transmission Cover
20	JD 7212 H	(-)	Cone, Bearing, Upper Shaft, Front
21	JD 7262 R	(-)	Cup, Bearing, Upper Shaft, Front
22	AL 4001 T	(-)	Retainer, Bearing, Upper Shaft, Front
23	JD 7397 T	(-)	Cone, Bearing, Lower Shaft, Rear
24	JD 7421 T	(-)	Cup, Bearing, Lower Shaft, Rear
25	JD 7399 T	(-)	Cone, Bearing, Differential (2 Used)
26	JD 7423 T	(-)	Cup, Bearing, Differential (2 Used)
27	JD 8106 R	(-)	Cone, Bearing, Upper Shaft, Rear, and Lower Shaft, Front (2 Used)
28	JD 7428 R	(-)	Cup, Bearing, Upper Shaft, Rear, and Lower Shaft Front (2 Used)
29	L 389 T	(-)	Pin, Dowel, Transmission Case to Frame (2 Used)
30	L 446 T	(-)	Shim, Lower Shaft, Rear, .003"
	L 447 T	(-)	Shim, Lower Shaft, Rear, .005"
	L 448 T	(-)	Shim, Lower Shaft, Rear, .010"
31	L 4019 T	(-)	Washer, Bevel, Lower Shaft
32	L 4024 T	(-)	Cover, Bearing, Lower Shaft, Front
33	L 4025 T	(-)	Gasket, Lower Shaft Front Bearing Cover
34	L 4031 T	(-)	Washer, Plain, Lower Shaft
35	L 4030 T	(-)	Nut, Hex., Slotted, Lower Shaft
36	L 4039 T	(-)	Shim, Lower Shaft, Front, .010"
	L 4040 T	(-)	Shim, Lower Shaft, Front, .005"
	L 4041 T	(-)	Shim, Lower Shaft, Front, .002"
37	L 467 T	(-)	Ball, Poppet (5 Used)
38	L 468 T	(-)	Spring, Poppet Ball (2 Used)
39	L 497 T	(-)	Shim, Differential, .003"
	L 498 T	(-)	Shim, Differential, .005"
	L 499 T	(-)	Shim, Differential, .010"
	L 500 T	(-)	Shim, Differential, .030"
40	19H 1004 T	(-)	Screw, Cap, Differential Bearing Caps, 1/2" x 2-1/4"
41	L 505 T	(-)	Cover, Differential
42	L 506 T	(-)	Gasket, Differential Cover
43	L 602 T	(-)	Spring, Governor Control Rod Ratchet Plate
44	15H 257 T	(-)	Plug, Pipe, 3/4" (3 Used)
45	30H 7 T	(-)	Plug, Expansion, Transmission Cover Assembly (4 Used)
46	25H 73 T	(-)	Pin, Groov-, Shift Forks to Shift Rails
47	AL 4011 T	(-)	Fork, Shift, First and Reverse Speeds
48	AL 4012 T	(-)	Fork, Shift, Second and Third Speeds
49	AL 4016 T	(-)	Shaft, Reverse Idler Gear
50	L 4017 T	(-)	Rail, Shift, First and Reverse Speeds
51	L 4018 T	(-)	Rail, Shift, Second and Third Speeds
52	L 4020 T	(-)	Plug, Screw, Poppet Spring
53	L 4029 T	(-)	Screw, Lock, Reverse Idler Shaft
54	L 4036 T	(-)	Shim, Upper Shaft Bearing Retainer, .010"
	L 4037 T	(-)	Shim, Upper Shaft Bearing Retainer, .005"
	L 4038 T	(-)	Shim, Upper Shaft Bearing Retainer, .002"



BRAKE ASSEMBLY

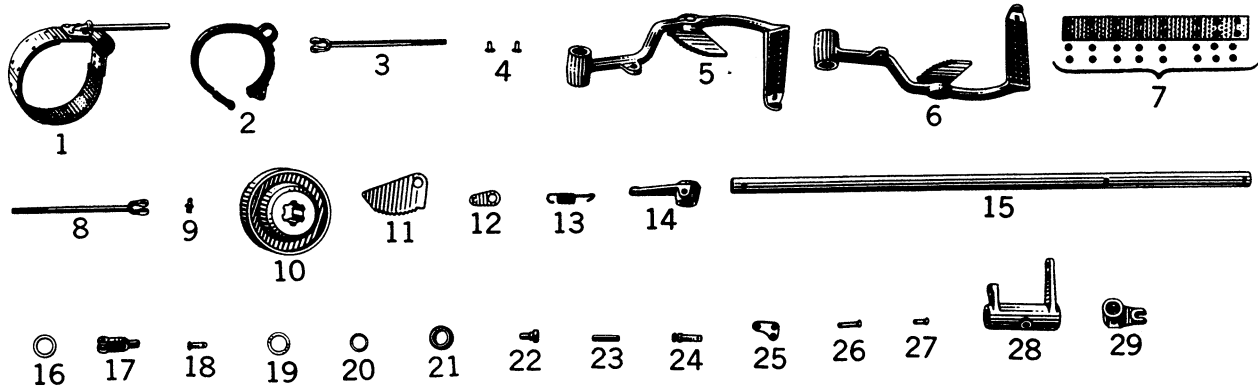

19620

Key	Part No.	Serial No.	Description
1	AL 2011 T	(-IL50816)	Band, Brake, with Lining (2 Used)
2	AL 20127 T	(IL50817-	Band, Brake, with Lining (2 Used)
3	AL 2028 T	(-)	Rod, Brake Pedal (2 Used)
4	(AL 2177 T	(-)	Rivets, Brake Band Lining, Short (Pkg. of 100)
	AL 20131 T	(IL50817-	Rivets, Brake Band Lining, Long (Pkg. of 100)
5	AL 2302 T	(-)	Pedal, Brake, with Lock, R.H.
6	AL 2303 T	(-)	Pedal, Brake, with Lock, L.H.
7	(AL 2878 T	(-IL50816)	Lining, Brake, with Rivets (2 Used)
	AL 20130 T	(IL50817-	
8	AL 20125 T	(IL50817-	Rod, Brake Band (2 Used)
9	JD 7759	(-)	Fitting, Grease, Straight, Brake Pedals and Bell Crank (3 Used)
10	AL 20294 T	(-)	Drum, Brake (2 Used)
11	L 178 T	(-)	Lock, Brake Pedal (2 Used)
12	L 198 T	(-)	Clip, Brake Spring (2 Used)
13	L 207 T	(-)	Spring, Brake Link
14	AL 20295 T	(-)	Lever, Right End of Brake Cross Shaft for Operating L.H. Brake
15	L 211 T	(-)	Shaft, Brake Cross
16	L 258 T	(-)	Washer, Plain, Brake Anchor Pin (2 Used)
17	L 299 T	(-)	Yoke, Brake Pedal Adjusting (2 Used)
18	L 307 T	(-)	Pin, Brake Cross Shaft Levers to Brake Rods, and Brake Rods to Brake Pedals (4 Used)
19	L 308 T	(-)	Washer, Plain, Bell Crank and Brake Pedals (3 Used)
20	L 357 T	(-)	Ring, Snap, Brake Pedal Shaft (2 Used)
21	L 668 T	(-)	Bushing, Brake Cross Shaft (3 Used)
22	L 669 T	(-)	Rivet, Brake Lock to Pedal (2 Used)
23	25H 124 T	(-)	Pin, Groov-, Brake Levers to Brake Cross Shaft (2 Used)
24	(L 359 T	(-IL50816)	Pin, Grooved Head, Brake Band Yoke (2 Used)
	L 4406 T	(IL50817-	
25	L 4601 T	(IL50817-	Plate, Pivot, Brake Rod Yoke to Brake Band (2 Used)
26	L 4602 T	(IL50817-	Pin, Pivot Plate to Band, Long (2 Used)
27	L 4603 T	(IL50817-	Pin, Pivot Plate to Band, Short (2 Used)
28	AL 4609 T	(-)	Crank, Bell, R.H. Brake
29	AL 4610 T	(-)	Lever, Left End of Brake Cross Shaft
..	AL 20129 T	(-IL50816)	Brake Change-Over Assembly (Not Illustrated)
..	L 256 T	(-IL50816)	Spring, Brake Band (2 Used) (Not Illustrated)
..	L 324 T	(-IL50816)	Yoke, Brake Band Adjusting (2 Used) (Not Illustrated)



FINAL DRIVE ASSEMBLY

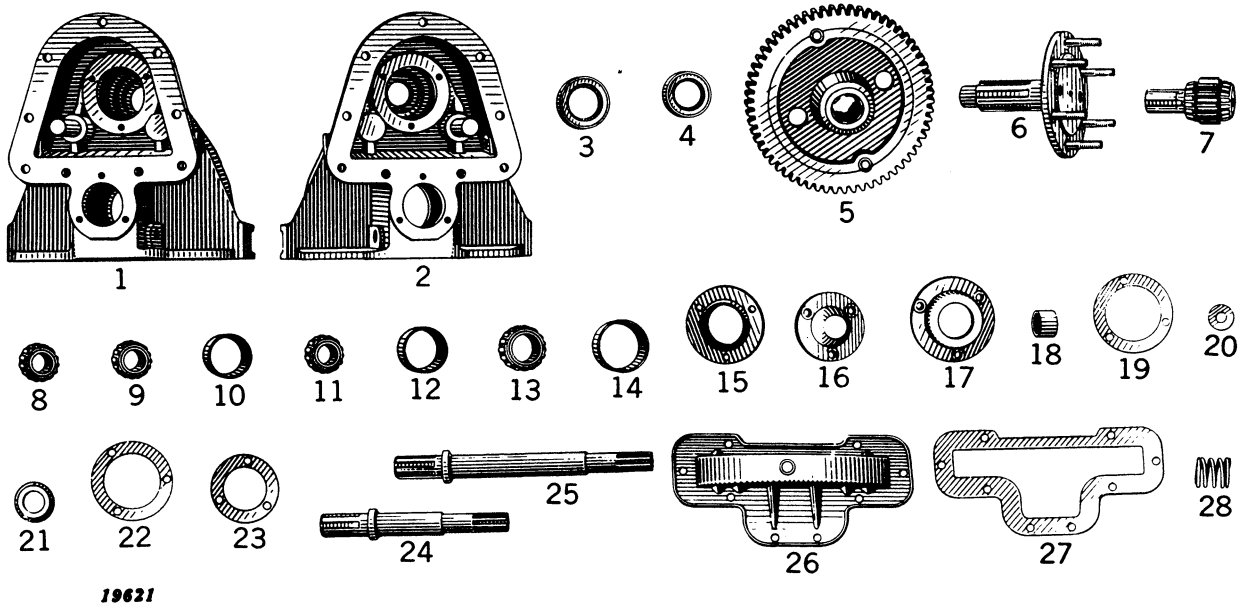

19621

Key	Part No.	Serial No.	Description
1	AL 2016 T	(-)	Housing, with Brake Anchor Pin, R.H.
2	AL 2017 T	(-)	Housing, with Brake Anchor Pin, L.H.
3	AL 2020 T	(-)	Seal, Oil, Flanged Shaft (2 Used)
4	AL 2021 T	(-)	Seal, Oil, Pinion Shaft (2 Used)
5	AL 2013 T	(-)	Gear with Spider (2 Used)
6	AL 2312 T	(-)	Shaft, Flanged with Six Rear Wheel Bolts (2 Used)
7	AL 2418 T	(-)	Pinion Final Drive with Bearing Cones (2 Used)
8	JD 7243 T	(-)	Cone, Bearing, Pinion Shaft, Outer (2 Used)
9	JD 7372 T	(-)	Cone, Bearing, Pinion Shaft, Inner (2 Used)
10	JD 7262 R	(-)	Cup, Bearing, Pinion Shaft, Inner and Outer (4 Used)
11	JD 7209 R	(-)	Cone, Bearing, Flanged Shaft, Inner (2 Used)
12	JD 7259 R	(-)	Cup, Bearing, Flanged Shaft, Inner (2 Used)
13	JD 7395 R	(-)	Cone, Bearing, Flanged Shaft, Outer (2 Used)
14	JD 7418 R	(-)	Cup, Bearing, Flanged Shaft, Outer (2 Used)
15	AL 134 T	(-)	Quill, Pinion Shaft (2 Used)
16	AL 136 T	(-)	Quill, Flanged Shaft, Inner (2 used)
17	AL 619 T	(-)	Quill, Flanged Shaft, Outer (2 Used)
18	L 137 T	(-)	Sleeve, Pinion Shaft (2 Used)
19	L 160 T	(-)	Shim, Pinion Shaft Quill, .010"
	L 161 T	(-)	Shim, Pinion Shaft Quill, .005"
	L 162 T	(-)	Shim, Pinion Shaft Quill, .002"
20	L 139 T	(-)	Washer, Plain, Flanged Shaft (2 Used)
21	L 140 T	(-)	Washer, Bevel, Flanged Shaft (2 Used)
22	L 163 T	(-)	Gasket, Flanged Shaft Outer Quill (2 Used)
23	L 157 T	(-)	Shim, Flanged Shaft Inner Quill, .010"
	L 158 T	(-)	Shim, Flanged Shaft Inner Quill, .005"
	L 159 T	(-)	Shim, Flanged Shaft Inner Quill, .002"
24	AL 173 T	(-)	Shaft, Drive, L.H.
25	AL 177 T	(-)	Shaft, Drive, R.H.
26	AL 616 T	(-)	Pan, Oil, (2 Used)
27	L 169 T	(-)	Gasket, Oil Pan (2 Used)
28	AL 174 T	(-)	Spring, Brake Drum Retaining (2 Used)

Parts listed below are not illustrated.

15H 255 R	(-)	Plug, Pipe, Drain 3/8" (2 Used)
30H 21 T	(-)	Plug, Expansion, Final Drive Housing, 1-1/2" (2 Used)
15H 256 T	(-)	Plug, Pipe, Filler 1/2" (2 Used)



TRACTOR—MODEL "LI"

STEERING GEAR ASSEMBLY

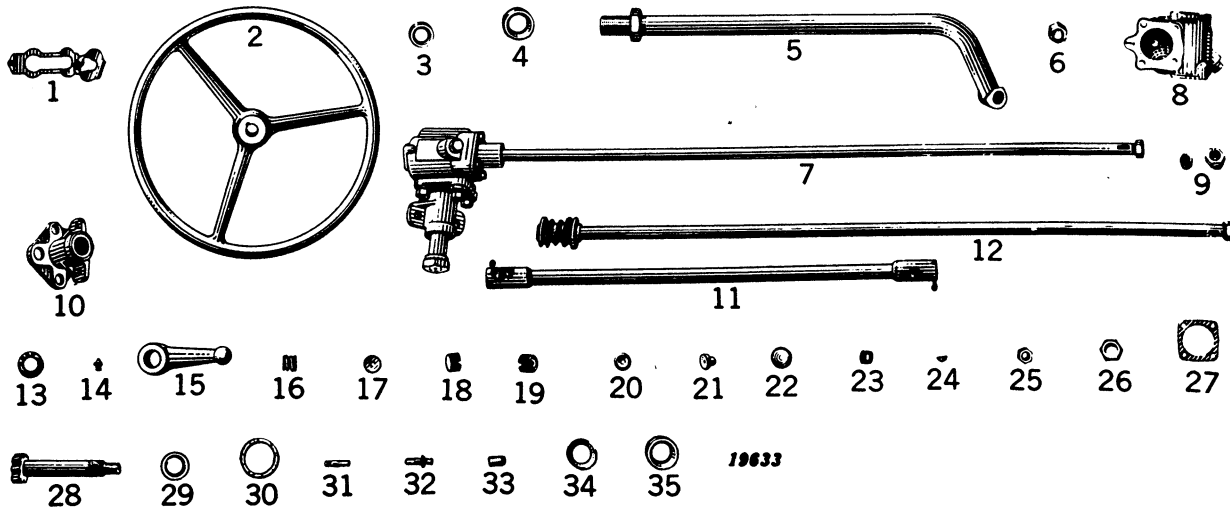

Key	Part No.	Serial No.	Description
1	AL 2079 T	(-)	Shield, Dust, Drag Link
2	AL 2180 T	(-)	Wheel, Steering
3	AL 2257 T	(-)	Seal, Oil, Steering Gear Base Assembly
4	AL 2258 T	(-)	Seal, Oil, Steering Column Cap
5	AL 2304 T	(-)	Support, Column for Steering Wheel with Bushing and Jam Nut
6	AL 2315 T	(-)	Nut, Steering Wheel
7	AL 2631 T	(-)	Gear, Steering, Complete, with Column
8	AL 2632 T	(-)	Housing, Assembly, Steering Gear
9	AL 2636 T	(-)	Sleeve, Eccentric, Assembly
10	AL 2639 T	(-)	Base, Steering Gear, with Two Bushings and Oil Seal
11	AL 2859 T	(-)	Link, Drag, less Dust Shield and Grease Fittings, Standard Axle
	AL 20001 T	(-)	Link, Drag, less Dust Shield and Grease Fittings, 50" Axle, 1-1/8" Spindles
12	AL 20275 T	(-IL51163)	Column, Steering, with Worm, Woodruff Key and Wheel Nut (Sub. for AL2634T)
	AL 20110 T	(IL51164-)	
13	AL 2635 T	(-IL51163)	Bearing, Ball, Worm Gear (2 Used)
	AL 20111 T	(IL51164-)	Bearing, Roller, Worm Gear (2 Used)
14	JD 7759	(-)	Fitting, Grease, Straight, Drag Link (2 Used)
15	L 4796 T	(-IL51017)	Arm, Pitman Ball, Steering Shaft (50" Axle)
	AL 368 T	(-)	Arm, Pitman Ball, Steering Shaft (Standard Axle)
16	L 423 T	(-)	Spring, Drag Link (2 Used)
17	L 424 T	(-)	Washer, Drag Link (2 Used)
18	L 425 T	(-)	Plug, Drag Link Adjusting, Rear End
19	L 426 T	(-)	Plug, Drag Link Adjusting, Front End
20	L 427 T	(-)	Seat, Ball, Drag Link, Flat End (Front of Rear End)
21	L 428 T	(-)	Seat, Ball, Drag Link, Stem End (Rear of Rear End and Rear of Front End)
22	L 955 T	(-IL51163)	Plug, Expansion, Steering Worm
	L 4590 T	(IL51164-)	Plug, Cupped, Steering Worm
23	L 989 T	(-)	Plug, Filler
24	26H 14 R	(-)	Key, Woodruff, Steering Wheel to Steering Column
25	14H 402 T	(-)	Nut, Hex., Jam, Pitman Ball Arm
26	14H 494 T	(-)	Nut, Hex., Jam, Steering Column Support to Frame
27	L 4080 T	(-)	Shim, Worm Gear Adjusting (.005")
28	AL 4085 T	(-)	Shaft, Cross, with Gear Sector
29	L 4086 T	(-)	Washer, Thrust, Cross Shaft
30	L 4087 T	(-)	Gasket, Base to Housing
31	L 4088 T	(-)	Stud, Steering Gear Base to Housing (2 Used)
32	L 4091 T	(-)	Stud, Worm Adjusting
33	L 4092 T	(-)	Screw, Thrust, Cross Shaft
34	L 4077 T	(-IL51163)	Cup, Bearing, Worm Gear, Lower
	L 4583 T	(IL51164-)	Cup, Bearing, Worm Gear, Lower
35	L 4584 T	(IL51164-)	Cup, Bearing, Worm Gear, Upper

Parts listed below are not illustrated.

AL 20112 T	(-)	Cap and Oil Seal, Steering Column
AL 20244 T	(-IL51163)	Cup, Bearing, and Oil Seal Change-Over Kit
L 534 T	(-)	Bushing, Steering Column Support
AL 20143 T	(IL51018-)	Link, Drag, less Dust Shield and Grease Fittings, 50" Axle, 1-3/8" Spindles



STANDARD AND 50-INCH FRONT AXLE ASSEMBLIES

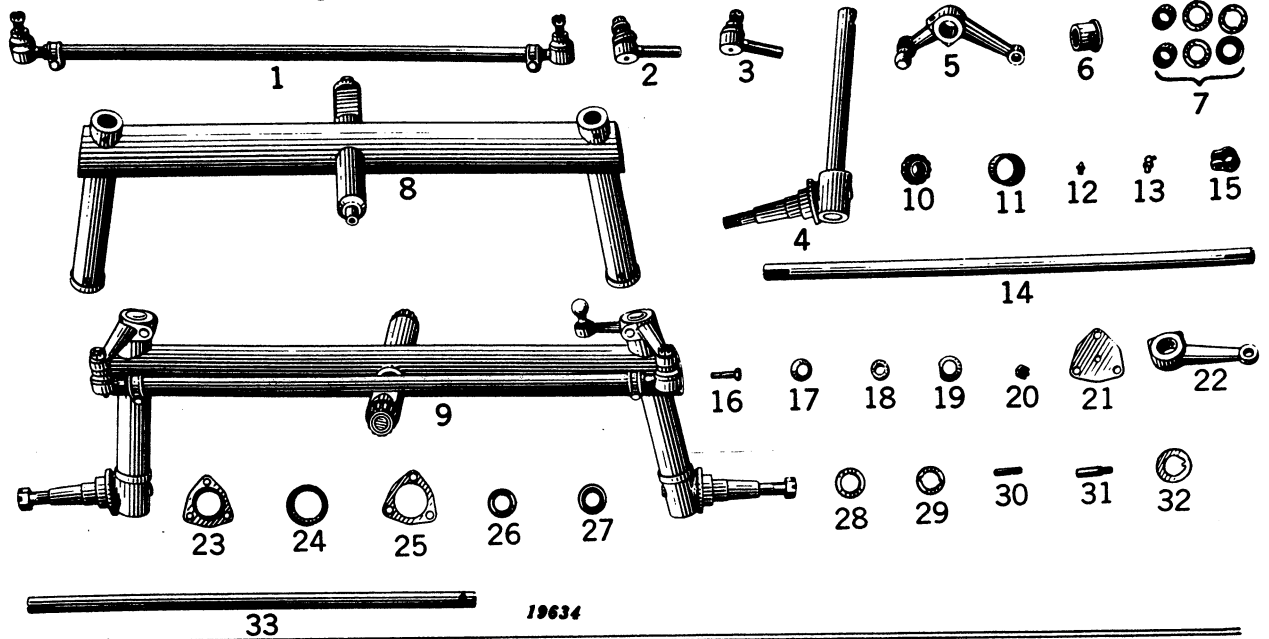

Key	Part No.	Serial No.	Description
1	(AL 2015 T	(-)	Rod, Tie, Complete, Standard Axle
	(AL 20142 T	(-)	Rod, Tie, Complete, 50" Axle
2	AL 2130 T	(-)	End, Tie Rod, Complete, R.H. Thread
3	AL 2156 T	(-)	End, Tie Rod, Complete, L.H. Thread
4	AL 2316 T	(-IL51017)	Knuckle, with Spindle, Standard Axle
	AL 20161 T	(IL51018-)	Knuckle, with Spindle, 50" Axle
	AL 20139 T	(IL51018-)	
5	AL 2317 T	(-IL51017)	Arm, Steering, with Ball, L.H., Standard Axle
	AL 20157 T	(IL51018-)	Arm, Steering, with Ball, L.H., 50" Axle
	AL 20141 T	(IL51018-)	
6	AL 657 T	(-IL51017)	Bushing, Spindle (4 Used)
	AL 4618 T	(IL51018-)	Bushing, Spindle, Thrust Washers, and Dust Seal Kit (2 Used)
7	AL 20149 T	(IL51018-)	
8	AL 2645 T	(-IL51017)	Axle, Front, Welded Assembly, with Bushings, Standard Axle
	AL 20173 T	(IL51018-)	Axle, Front, Welded, Assembly, with Bushings, Thrust Washer and Dust Seals, Standard Axle
	AL 20150 T	(IL51018-)	Axle, Front, Welded Assembly, with Bushings, Thrust Washer and Dust Seals, 50" Axle
9	AL 20160 T	(-)	Axle, Front, Assembly Complete, Standard Axle
10	JD 7358 R	(-)	Cone, Bearing, Pivot Shaft (2 Used)
11	JD 7250 R	(-)	Cup, Bearing, Pivot Shaft (2 Used)
12	(JD 7759	(-)	Fitting, Grease, Straight (4 Used)
	JD 7797	(-)	Fitting, Grease, Straight, Tie Rod Ends (2 Used)
13	JD 7760	(-)	Fitting, Grease, Angle (2 Used)
14	L 408 T	(-)	Rod, Tie Rod
15	L 409 T	(-)	Clamp, Tie Rod (2 Used)
16	L 410 T	(-)	Bolt, Tie Rod Clamp (2 Used)
17	L 417 T	(-)	Seat, Tie Rod Dust Cover (2 Used)
18	L 419 T	(-)	Washer, Rubber Tie Rod (2 Used)
19	L 418 T	(-)	Dome, Tie Rod Dust Cover (2 Used)
20	L 420 T	(-)	Nut, Hex., Slotted, Tie Rod End (2 Used)
21	L 633 T	(-)	Cap, Pivot Shaft Bearing (2 Used)
22	(AL 638 T	(-IL51017)	Arm, Steering, R.H.
	(AL 4617 T	(IL51018-)	Shield, Dust, Pivot Shaft Bearing, Inner (2 Used)
23	L 646 T	(-)	
24	L 647 T	(-IL51017)	Shield, Dust, Lower Spindle Bushing (2 Used)
25	(L 659 T	(-)	Shim, Pivot Shaft Bearing, .010"
	L 660 T	(-)	Shim, Pivot Shaft Bearing, .005"
	L 661 T	(-)	Shim, Pivot Shaft Bearing, .002"
26	L 4619 T	(IL51018-)	Washer, Thrust, Upper (2 Used)
27	L 4620 T	(IL51018-)	Washer, Thrust, Lower (2 Used)
28	L 4621 T	(IL51018-)	Seal, Felt, Spindle (2 Used)
29	L 4622 T	(IL51018-)	Washer, Spindle Dust Seal (2 Used)
30	25H 184 T	(-IL51017)	Pin, Groov, Steering Arm to Spindle (2 Used)
31	L 4624 T	(IL51018-)	Pin, Lock, Steering Arm to Spindle (2 Used)
32	24H 66 A	(-IL51017)	Washer, Plain, Top of Spindle (2 Used)
33	L 4633 T	(-)	Tube, Tie Rod

Part listed below is not illustrated.

AL 4615 T (IL51018-) Arm, Pitman Steering Gear



FRONT AND REAR WHEELS AND ASSOCIATED PARTS

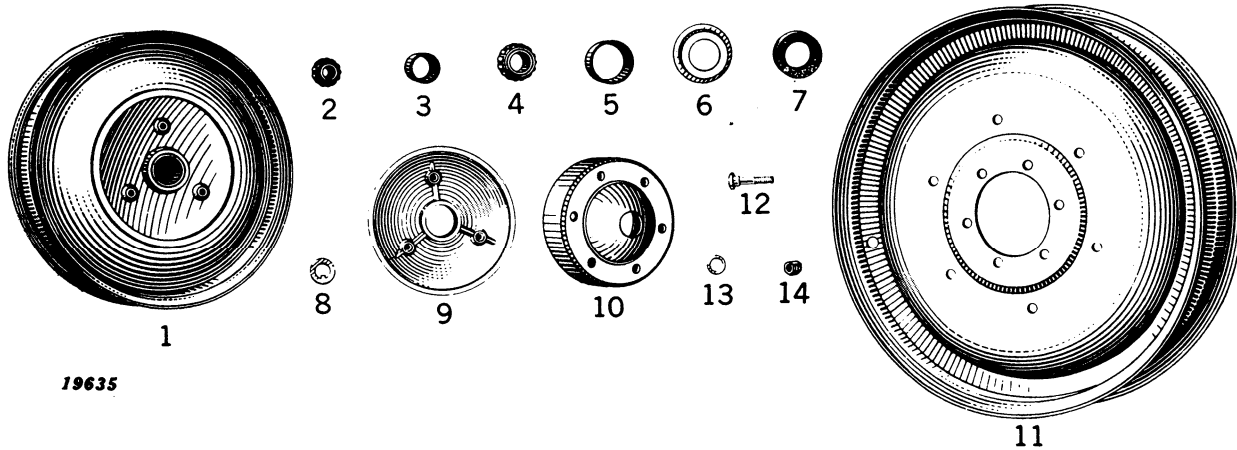

19635

Key	Part No.	Serial No.	Description
1	AL 2329 T	(-)	Wheel, Front, with Bearing Cups (2 Used)
2	JD 7358 R	(-)	Cone, Bearing, Small, Outer, Front Wheel (2 Used)
3	JD 7250 R	(-)	Cup, Bearing, Small, Outer, Front Wheel (2 Used)
4	JD 7243 T	(-)	Cone, Bearing, Large, Inner, Front Wheel (2 Used)
5	JD 7262 R	(-)	Cup, Bearing, Large, Inner, Front Wheel (2 Used)
6	L 105 T	(-)	Cup, Hub Felt Retainer, Front Wheel (2 Used)
7	L 106 T	(-)	Felt, Front Wheel Hub (2 Used)
8	M 824 T	(-)	Washer, Front Wheel Knuckle (2 Used)
9	AL 608 T	(-)	Cap, Front Wheel Hub (2 Used)
10	AL 397 T	(-)	Spacer, Rear Wheel (2 Used)
11	AL 2286 T	(-)	Wheel, Rear (2 Used)
12	L 4045 T	(-)	Bolt, Rear Wheel Attaching (12 Used)
13	L 4069 T	(-)	Washer, Rear Wheel Bolt (12 Used)
14	L 586 T	(-)	Nut, Rear Wheel Bolt (12 Used)

Parts listed below are not illustrated.

..	(21H 717 T	(-)	Screw, Mach., Hub Cap to Wheel, 5/16" x 1-1/2" (6 Used)
	(12H 10 R	(-)	Washer, Lock, Hub Cap to Wheel Screws, 5/16"
	AA 3401 R	(-)	Washer, Lock, Hub Cap to Wheel Screws, 5/16" (6 Used) (Box of 50)

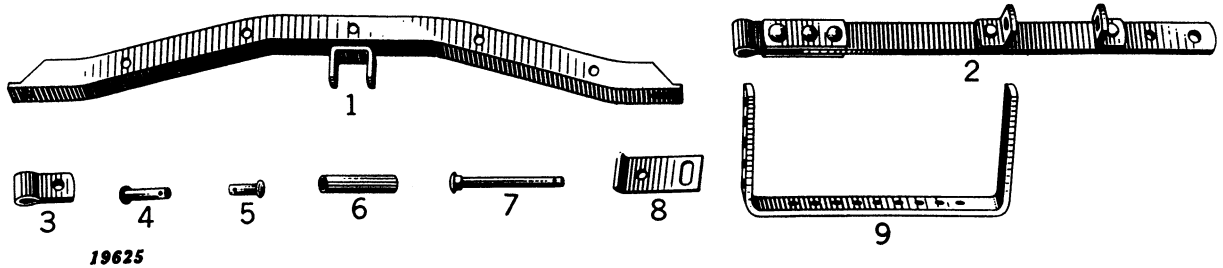

Key	Part No.	Serial No.	Description
1	AL 2066 T	(-)	Angle, Cross, Front
2	AL 2067 T	(-)	Link Assembly, Swinging
3	L 282 T	(-)	Eye, Swivel, Swinging Link to Cross Angle
4	L 286 T	(-)	Pin, Swinging Link to Swivel Eye
5	L 288 T	(-)	Pin, Swivel Eye to Cross Angle
6	L 294 T	(-)	Roller, Drawbar
7	L 295 T	(-)	Pin, Drawbar Roller
8	L 609 T	(-)	Bracket, Drawbar Support to Frame (2 Used)
9	L 297 T	(-)	Support, "U" Shaped, Rear Swinging Link

Parts listed below are not illustrated.

..	L 1149 T	(-)	Washer, Plain, Swinging Link to Drawbar Cross Angle
..	8H 532 T	(-)	Bolt, Mach., Rear Drawbar Support to Support Bracket, 1/2" x 1-1/2" (2 Used)
..	8H 631 T	(-)	Bolt, Mach., Rear Drawbar Support to Frame, 1/2" x 4-1/2" (2 Used)

BELT PULLEY ATTACHMENT

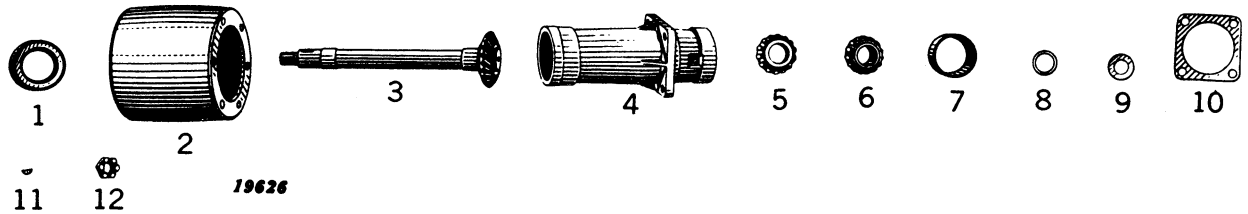

Key	Part No.	Serial No.	Description
1	AL 2124 T	(-)	Seal, Oil
2	AL 2206 T	(-)	Pulley, 6-3/8" Face)
3	AL 2367 T	(-)	Gear, Bevel, and Shaft Assembly
4	AL 2417 T	(-)	Quill, with Bearing Cups
5	JD 7212 H	(-)	Cone, Bearing, Outer
6	JD 7243 T	(-)	Cone, Bearing, Inner
7	JD 7262 R	(-)	Cup, Bearing, Inner and Outer (2 Used)
8	L 225 T	(-)	Shim, Spacer to Bearing, .002"
	L 226 T	(-)	Shim, Spacer to Bearing, .005"
	L 227 T	(-)	Shim, Spacer to Bearing, .010"
9	L 273 T	(-)	Washer, Belt Pulley Shaft Nut
10	L 536 T	(-)	Shim, Pulley Attachment to Clutch Shaft Housing, .002"
	L 537 T	(-)	Shim, Pulley Attachment to Clutch Shaft Housing, .005"
	L 538 T	(-)	Shim, Pulley Attachment to Clutch Shaft Housing, .010"
11	26H 19 R	(-)	Key, Woodruff, Belt Pulley to Shaft
12	14H 534 T	(-)	Nut, Hex., Slotted, Belt Pulley Retaining

Part listed below is not illustrated.

..	L 221 T	(-)	Spacer, Sleeve, Belt Pulley to Shaft
----	---------	-------	--------------------------------------

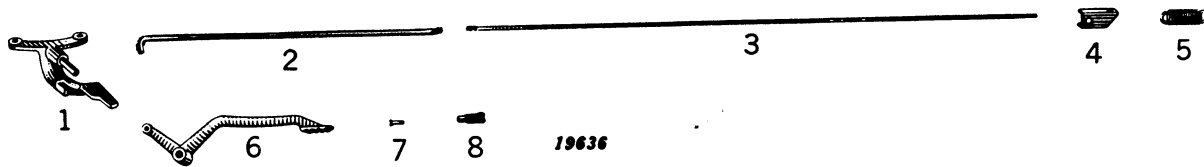

TRACTOR—MODEL "LI"**HIGH TRANSPORT SPEED ATTACHMENT**

Key	Part No.	Serial No.	Description
1	AL 2377 T	(-)	Bracket Assembly, Pedal
2	L 4363 T	(-)	Rod, Governor Foot Control, Front
3	L 964 T	(-)	Rod, Governor Foot Control, Rear
4	L 4362 T	(-)	Guide, Governor Foot Control Rod
5	L 966 T	(-)	Spring, Governor Foot Control Rod
6	AL 968 T	(-)	Pedal, Governor Control
7	L 985 T	(-)	Pin, Governor Control Rod Yoke
8	L 987 T	(-)	Yoke, Governor Control Pedal, Rod Adjusting

TOOL BOX AND SICKLE CARRIER ASSEMBLIES

(Parts listed below are not illustrated)

Key	Part No.	Serial No.	Description
..	AL 2925 T	(-)	Support, Tool Box, R.H.
..	AL 2926 T	(-)	Support, Tool Box, L.H.
..	AL 2927 T	(-)	Box, Tool, less Supports
..	AL 2942 T	(-)	Carrier, Sickle, Rear, Outer
..	AL 2943 T	(-)	Carrier, Sickle, Rear, Inner
..	L 4433 T	(-)	Guard, Sickle, Wood
..	L 4434 T	(-)	Bracket, Sickle Carrier, Front
..	L 4435 T	(-)	Clamp, Sickle Carrier, Front
..	L 4436 T	(-)	Clamp, Sickle, Carrier, Rear (2 Used)
..	M 2 D	(-)	Nut, Tail, 7/16"
..	M 534 T	(-)	Nut, Wing, 5/16" (2 Used)



DECALCOMANIA SET

JOHN DEERE

1

**JOHN DEERE
MODEL LI TRACTOR**

EVERY DAY
Check oil level in engine.
Remove dirt from Air Cleaner cup
and put in new oil (SAE-30).

ONCE A WEEK
Grease 14 Alemite Fittings.
(Use gun grease)

EVERY TWO WEEKS,
or at end of 60 hours operation
Drain and refill crankcase in
engine—Use SAE-30 oil in summer,
use SAE-10W oil in cold weather—
crankcase holds three quarts.
Oil Fan Bearing—(Same oil as in engine)
Check oil level in following:
Clutch Shaft Housing } —(SAE-90 Oil)
Transmission }
Final Drives }

TWICE A YEAR
Pack front wheel bearings with grease.
Drain and refill with oil to plug level:
Clutch Shaft Housing
Transmission and Differential
Final Drives
Fill Steering Gear Housing to top.
(Use SAE-140 Oil)

TIRES
Front—28 lbs. air pressure
Rear—12 lbs. air pressure

PRINTED IN U.S.A.

2

3

UNITED OIL BATH AIR CLEANER
SERVICE CLEANER DAILY.—REMOVE AND CLEAN
CUP AND BAFFLE.—INSERT BAFFLE INTO CUP AND
REFILL TO INDICATED OIL LEVEL WITH ENGINE
OIL. INSPECT GASKET BEFORE REINSTALLING CUP
—OIL MUST FLOW FREELY—
UNITED SPECIALTIES CO.
UNITED AIR CLEANER DIV CHICAGO ILL
MADE IN U.S.A. PATENTS PENDING

4

SAFETY FIRST
DRIVE TRACTOR AT SAFE
SPEEDS. REDUCE SPEED
WHEN TURNING OR
APPLYING INDIVIDUAL
BRAKES. DRIVE SLOWLY
OVER ROUGH GROUND

19637

5

JOHN DEERE
QUALITY FARM
EQUIPMENT

Key	Part No.	Serial No.	Description
1	AL 20048 T	(-)	Decalcomania Kit, Consisting of: "John Deere" Decalcomania for Front and Sides of Engine House Assembly (3 Used)
2			"Servicing Instructions" Decalcomania for Rear of Engine House
3			"Servicing Instructions" Decalcomania for Air Cleaner
4			"Safety First" Decalcomania for Back of Seat
5			"Leaping Deer" Decalcomania For Rear of Hood



HARDWARE LIST

CAP SCREWS

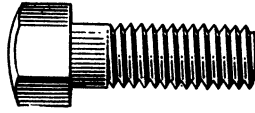

Part No.	Size	Attaches to Part No.	Description
19H 12 R	5/16" x 1"	AB 1204 R	Generator Attachment (2 used)
19H 211 R	3/8" x 1"	AL 2070 T	Rear Plate Assembly to Frame (4 used)
19H 105 R	5/16" x 3/4"	AL 2122 T	Rear Oil Seal Plate (5 used)
19H 100 T	5/16" x 5/8"	AL 2159 T	Transmission Lower Bearing Cap (3 used)
19H 100 T	5/16" x 5/8"	AL 2203 T	Fender to Footrest (R.H.) (2 used)
19H 100 T	5/16" x 5/8"	AL 2204 T	Fender to Footrest (L.H.) (2 used)
19H 332 R	7/16" x 1-1/4"	AL 2213 T	Belt Pulley Attachment to Clutch Shaft Housing (2 used)
19H 201 T	3/8" x 3/4"	AL 2266 T	Radiator to Radiator Support (2 used)
19H 448 R	1/2" x 1-1/4"	AL 2349 T	Water Inlet Elbow to Cylinder Block (2 used)
19H 112 R	5/16" x 1"	AL 2367 T	Belt Pulley Gear Case (6 used)
19H 230 T	3/8" x 1-1/2"	AL 2377 T	High Speed Attachment Pedal Bracket (2 used)
19H 332 T	7/16" x 1-1/4"	AL 2417 T	Belt Pulley Quill to Tractor (4 used)
19H 190 T	5/16" x 5/8"	AL 2464 T	Fender to Footrest (L.H.) (2 used)
19H 211 R	3/8" x 1"	AL 2601 T	Transmission and Differential Case to Frame (8 used)
19H 207 T	3/8" x 7/8"	AL 2605 T	Transmission Cover to Transmission (4 used)
19H 100 T	5/16" x 5/8"	AL 2657 T	Oil Pan Attaching (12 used)
19H 207 T	3/8" x 7/8"	AL 2663 T	Gear Cover (5 used)
19H 100 T	5/16" x 5/8"	AL 2693 T	Flywheel Pan (4 used)
19H 221 R	3/8" x 1-1/4"	AL 2753 T	Governor Case to Gear Cover (2 used)
19H 105 R	5/16" x 3/4"	AL 2743 T	Rear Oil Seal Plate with Oil Seal (5 used)
19H 239 T	3/8" x 1-3/4"	AL 2763 T	Engine House Rear Support (3 used)
19H 105 R	5/16" x 3/4"	AL 2823 T	Battery Ground Strap
19H 37 T	1/4" x 1-1/2"	AL 2827 T	Oil Pump Cover (4 Used)
19H 652 T	5/8" x 1-1/4"	AL 2870 T	Cylinder Block to Frame (Rear) (2 Used)
19H 652 T	5/8" x 1-1/4"	AL 2871 T	Cylinder Block to Frame (Rear) (2 Used)
19H 207 T	3/8" x 7/8"	AL 2928 T	Tool Box to Supports (4 used)
19H 239 T	3/8" x 1-3/4"	L 121 T	Clutch Housing Rear Bearing Quill to Clutch Housing (3 used)
19H 211 R	3/8" x 1"	L 134 T	Final Drive Quill (6 used)
19H 211 R	3/8" x 1"	L 136 T	Final Drive Quill (6 used)
19H 199 R	3/8" x 5/8"	L 505 T	Differential Cover (8 used)
19H 317 T	7/16" x 3/4"	L 535 T	Clutch Housing Cover to Clutch Housing (4 used)
19H 207 T	3/8" x 7/8"	L 616 T	Final Drive Oil Pan to Final Drive Housing (16 used)
19H 211 R	3/8" x 1-1/4"	L 619 T	Final Drive Outer Quill to Final Drive Housing (6 used)
19H 230 T	3/8" x 1-1/2"	L 830 T	Valve Cover (Curved) (2 used)
19H 129 T	5/16" x 1-3/8"	L 4001 T	Bearing Retainer on Front of Upper Shaft (4 used)
19H 100 T	5/16" x 5/8"	L 4024 T	Bearing Cover for Front End of Lower Shaft (3 used)
19H 129 T	5/16" x 1-3/8"	L 4054 T	Propeller Shaft Guard Support (2 used)
19H 211 R	3/8" x 1"	L 4116 T	Water Outlet to Cylinder Block (2 Used)
19H 211 R	3/8" x 1"	L 4150 T	Clutch Carrier Sleeve (3 Used)
19H 448 R	1/2" x 1-1/4"	L 4164 T	Engine Support (Front) to Cylinder Block (2 Used)
19H 105 R	5/16" x 3/4"	L 4199 T	Generator Adjusting Link (2 Used)
19H 105 R	5/16" x 3/4"	L 4200 T	Generator Bracket (2 Used)
19H 110 R	5/16" x 7/8"	L 4252 T	Governor Control Rod Bracket
19H 112 R	5/16" x 1"	L 4312 T	Light Bracket Clamp (2 Used)
19H 221 R	3/8" x 1-1/4"	L 4312 T	Light Bracket (2 Used)
19H 112 R	5/16" x 1"	L 4434 T	Sickle Carrier Front Bracket (2 used)
19H 354 T	7/16" x 2"	AL 2016 T	Final Drive to Rear Housing (R.H.) (10 used)
19H 354 T	7/16" x 2"	AL 2017 T	Final Drive to Rear Housing (L.H.) (10 used)
19H 222 T	3/8" x 1-1/4"	AL 2639 T	Steering Gear Base to Frame (2 used)
19H 364 T	7/16" x 2-1/4"	AL 2016 T	Fender and Final Drive to Rear Housing (R.H.) (8 used)
19H 364 T	7/16" x 2-1/4"	AL 2017 T	Fender and Final Drive to Rear Housing (L.H.) (8 used)
19H 202 T	3/8" x 3/4"	AL 2840 T	Air Cleaner Attaching (3 used)
19H 278 T	3/8" x 3"	AL 2908 T	Magneto Attaching
19H 449 T	1/2" x 1-1/4"	L 139 T	Washer to Inner End of Flanged Shaft (2 used)
19H 240 T	3/8" x 1-3/4"	L 633 T	Pivot Shaft Bearing Cap (6 used)
19H 240 T	3/8" x 1-3/4"	L 646 T	Dust Shield, Pivot Shaft Bearing (6 used)

CARRIAGE BOLTS

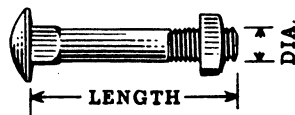

3H 675 T	5/8" x 1-3/4"	AD 1606 R	Seat to Seat Bracket
----------	---------------	-----------	----------------------



HARDWARE LIST—Continued

MACHINE SCREWS



Part No.	Size	Attaches to Part No.	Description
21H 597 R	1/4" x 1/2"	AL 2975 T	Tail Light (2 used)
21H 597 R	1/4" x 1/2"	L 602 T	Governor Control Rod Lock Spring to Support on Transmission
21H 717 T	5/16" x 1-1/2"	L 608 T	Hub Cap to Front Wheel (3 used)
21H 588 T	1/4" x 3/8"	L 689 T	Timing Hole Cover to Flywheel Housing
21H 928 T	5/16" x 1/2"	AL 2267 T	Engine House Base and Shield Assembly to Bottom of Engine House Grille (4 used)
21H 945 T	3/8" x 3/4"	AL 2267 T	Engine House Base and Shield Assembly to Radiator Support (2 used)
21H 931 T	5/16" x 3/4"	AL 2268 T	Engine House Grille to Crank Guide
21H 931 T	5/16" x 3/4"	AL 2421 T	Crank Guide to Grille
21H 928 T	5/16" x 1/2"	AL 2866 T	Propeller Shaft Guard to Top and Sides Assembly (2 used)
21H 930 T	5/16" x 5/8"	AL 2866 T	Propeller Shaft Guard to Transmission (2 used)
21H 928 T	5/16" x 1/2"	AL 2902 T	Engine House Top and Sides Assembly to Frame Bracket (2 used)
21H 928 T	5/16" x 1/2"	AL 2902 T	Engine House Top and Sides Assembly to Rear Support (2 used)
21H 928 T	5/16" x 1/2"	AL 2902 T	Engine House Top and Sides Assembly to Grille (5 used)
21H 931 T	5/16" x 3/4"	AL 2902 T	Engine House Top and Sides Assembly to Rear Support (4 used)
21H 937 T	5/16" x 1-1/2"	L 965 T	Governor Control Rod Guide to Engine House Base and Shield Assembly

MACHINE BOLTS



7H 317 R	3/8" x 1"	AL 2824 T	Battery Mounting Plate to Frame (4 used)
7H 909 R	1/2" x 3-3/4"	AL 2925 T	Tool Box Support to Frame (R.H.) (2 used)
7H 909 R	1/2" x 3-3/4"	AL 2926 T	Tool Box Support to Frame (L.H.) (2 used)
7H 944 R	1/2" x 4-1/2"	L 297 T	Rear Drawbar Support to Frame (2 used)
7H 739 R	1/2" x 1-1/2"	L 609 T	Rear Drawbar Support to Drawbar Support Bracket (2 used)
8H 1566 T	3/4" x 6-1/2"	L 547 T	Seat Spring to Seat Bracket
8H 528 T	1/2" x 1-1/4"	L 4164 T	Front Engine Support to Frame

HEXAGON NUTS

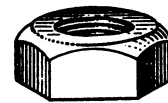
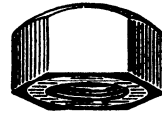
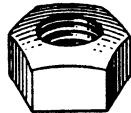

		Plain	Semi-Finished	Jam
14H 534 T	3/4"	AL 2206 T	Belt Pulley	
14H 534 T	3/4"	AL 2329 T	Front Wheel (2 used)	
14H 344 A	7/16"	AL 2660 T	Gear Cover Thrust Screw (2 used)	
14H 477 T	5/8"	L 4168 T	Starter Attaching Screw	
14H 471 T	1/2"	L 4121 T	Oil Pump Attaching Screw	
14H 465 T	3/8"	L 4238 T	Governor Lever Stop Screw	
14H 495 T	1-1/4"	AL 2304 T	Steering Column Support to Rear Housing	
14H 463 T	5/16"	AL 2659 T	Clutch Throw-Out Rod	
14H 463 T	5/16"	L 299 T	Adjusting Yoke Rod (2 used)	
14H 466 T	3/8"	L 324 T	Adjusting Yoke to Rod (2 used)	
14H 402 T	3/4"	L 368 T	Pitman Ball Arm	
14H 630 T	No. 10-32	L 964 T	Adjusting Yoke to Governor Foot Control Rod (Rear)	
14H 701 R	9/16"	L 4092 T	Steering Gear Shaft Thrust Screw	
14H 402 T	3/4"	L 4506 T	Pitman Ball Arm (Adjustable Axle)	

EXPANSION PLUGS



30H 21 T	1-1/2"	AL 2016 T	Final Drive Housing (R.H.)
30H 21 T	1-1/2"	AL 2017 T	Final Drive Housing (L.H.)
30H 7 T	5/8"	AL 2605 T	Transmission Cover (4 used)
30H 7 T	5/8"	AL 2753 T	Governor Case
L 4289 T	1-1/4"	AL 2871 T	Cylinder Block (Heat Treated Welsh Plug) (2 used)

TRACTOR—MODEL "LI"**HARDWARE LIST—Continued****PIPE FITTINGS**

Part No.	Size	Attaches to Part No.	Description
15H 256 T	1/2"	AL 2016 T	Final Drive (R.H.)
15H 256 T	1/2"	AL 2017 T	Final Drive (L.H.)
15H 254 R	1/4"	AL 2349 T	Lower Water Elbow
15H 257 T	3/4"	AL 2601 T	Transmission and Differential Case (3 used)
15H 255 R	3/8"	L 616 T	Final Drive Oil Pan (2 used)
15H 253 R	1/8"	L 1189 T	Elbow on Cylinder Block
15H 255 R	3/8"	L 4123 T	Clutch Shaft Housing (2 used)

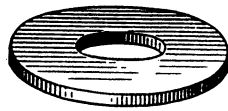
WASHERS—PLAIN

L 1149 T	5/8"	AD 1606 R	Seat to Seat Bracket
L 1149 T	5/8"	AL 2067 T	Drawbar Swinging Link to Drawbar Cross Angle
L 1198 T	5/16"	AL 2754 T	Governor Wire, Rear End
L 1198 T	5/16"	AL 2858 T	Battery Cover (4 used)
24H 447 T	5/8"	AL 2835 T	Headlight
24H 161 A	7/16"	L 968 T	Governor Control Pedal to Pedal Bracket Assembly

COTTER PINS

11H 3 R	1/16" x 1/2"	
11H 19 R	3/32" x 5/8"	
11H 20 T	3/32" x 3/4"	
11H 52 T	1/8" x 2-1/2"	
11H 60 T	5/32" x 1"	
11H 62 R	5/32" x 1-1/4"	
11H 64 T	5/32" x 1-1/2"	
AA 3408 R	3/32" x 1/2"	(11H18R, Box of 100)
AA 3411 R	1/8" x 3/4"	(11H40H, Box of 100)
AA 3412 R	1/8" x 1"	(11H41R, Box of 100)
AA 3414 R	1/8" x 1-1/2"	(11H45R, Box of 100)
AA 3420 R	1/4" x 1-1/2"	

LOCK WASHERS

12H 7 R	No. 10 SAE Medium	
12H 44 T	5/8" SAE Light	
12H 58 T	1-1/2" SAE Light	
12H 68 R	5/16" SAE Heavy	
AA 3400 R	1/4" SAE Medium	(12H9R, Box of 50)
AA 3401 R	5/16" SAE Medium	(12H10R, Box of 50)
AA 3402 R	3/8" SAE Medium	(12H11R, Box of 50)
AA 3403 R	7/16" SAE Medium	(12H12R, Box of 50)
AA 3404 R	1/2" SAE Medium	(12H13R, Box of 50)
AA 3405 R	9/16" SAE Medium	(12H14R, Box of 50)
AA 3406 R	5/8" SAE Medium	(12H15R, Box of 25)
AA 3407 R	3/4" SAE Medium	(12H17R, Box of 25)

NUMERICAL INDEX MODEL "LI" TRACTOR

Part No.	Page	Key	Part No.	Page	Key	Part No.	Page	Key	Part No.	Page	Key
10-2182	23	39	3219	29	58	817532	31	57	14H 478 T	19	2
13- 719	23	15	3497A	27	24	819104	31	41	14H 494 T	42	26
14- 175	23	6	3538	27	66	819362	33	23	14H 495 T	49	..
15- A91	23	8	3539	27	68	820524	31	8	14H 534 T	45	12
15- 33	23	25		29	38	821524	33	38	14H 583 T	36	10
15- 186	26	6	3945	29	40	833602	33	41	14H 605 R	29	32
	28	6	4140	26	3	1116809	31	35	14H 608 R	31	26
15- 223	23	9		28	3	1836664	31	18	14H 630 T	49	..
15- 397	23	43	4210	29	59	1841027	31	24	14H 631 R	31	1
15- 443	23	2	5077	29	52	1843646	31	52	14H 644 T	19	9
16- 80	23	46	5446	27	47	1849782	33	..	14H 701 R	49	..
16- 449	23	36	5516	29	24	1850810	33	48	14H 732 R	33	35
16- 480	27	56	5518	29	20	1850811	33	47	14H 774 R	23	52
16- 583	26	7	5519	29	19	1855629	33	49	15H 197 R	7	..
16- 738	27	55	5520	29	23	1858749	31	30	15H 219 T	7	10
24- 153	23	27	5532	29	51	1858753	31	29	15H 253 R	5	..
24- 262	23	32	5536	29	61	1858754	31	31	15H 254 R	7	5
24- 340	23	5	5610	29	43	1860639	33	45	15H 255 R	37	22
24- 425	23	48	5620	29	62	1861076	33	39	15H 256 T	41	..
24- 480	23	41	5622	29	67	1865182	33	14	15H 257 T	12	6
26- 656	23	30	5633	29	47	1867168	31	53	16X 477B	27	57
26- 657	23	45	5644	29	60	1868804	33	50	19H 12 R	48	..
27- 144	23	49	5926	29	22	1872505	33	42	19H 37 T	15	15
27- 154	23	50	6199	29	18	1872638	31	3	19H 100 T	12	5
27- 539	23	38	6204	29	15	1872661	31	32	19H 105 R	9	2
28- 49	23	28	6424	28	1	1873774	33	13	19H 110 R	23	20
29- 81	23	23	6425	28	2	1880225	31	22	19H 112 R	48	..
29- 530	23	24	6468	29	55	1880254	33	32	19H 129 T	48	..
30- 600	23	33	10383	29	45	1881250	31	33	19H 190 T	36	..
32- 27	23	34	10407	29	57	1881251	31	34	19H 199 R	48	..
43- 108	23	4	114998	33	12	1881869	33	29	19H 201 T	48	..
44- 38	23	13	200182	31	25	1881998	31	6	19H 202 T	48	..
44- 39	23	47	451608	31	15	1882323	33	33	19H 207 T	7	52
46- 473	23	21	802691	33	11	1882324	33	51	19H 211 R	7	37
47- 611	23	35	802730	31	21	1886923	33	9	19H 221 R	48	..
49- 101L	23	18	804000	31	47	1920102	31	54	19H 222 T	48	..
49- 209	23	37	804076	31	12	1904669	33	40	19H 230 T	48	..
55- 231	23	14	805057	33	46	1904829	31	51	19H 239 T	48	..
62- 167	23	16	806915	31	48	1911097	31	14	19H 240 T	48	..
67- 523	23	12	809053	33	6	1911263	31	49	19H 278 T	27	28
78- 62	23	26	809062	31	11	1912008	31	39	19H 317 T	48	..
78- 154	23	3		33	18	1995603	25	12	19H 332 R	48	..
78- 184	23	42	809551	31	17				19H 332 T	48	..
78- 322	23	7	809593	31	38	3H 675 T	35	..	19H 354 T	48	..
82- 16	23	29		33	30	7H 317 R	49	..	19H 364 T	48	..
95- 78	23	44	809614	31	64	7H 739 R	49	..	19H 448 R	48	..
99- 7	23	40	809642	31	19	7H 909 R	49	..	19H 449 T	48	..
227- 738	23	10	809644	31	23	7H 944 R	49	..	19H 467 R	7	4
233- 536	23	17	809658	31	59	8H 165 T	36	..	19H 652 T	48	..
286- 605	23	..	809688	31	66	8H 528 T	49	..	19H 1004 T	39	40
1118	27	43	809698	31	58	8H 532 T	45	..	21H 238 R	31	36
1152	27	22	809824	31	65	8H 631 T	45	..	21H 395 R	33	24
1153	27	23	809945	31	56	8H 1566 T	35	..	21H 412 T	19	15
1194	27	64	809961	31	42	11H 3 R	17	1	21H 588 T	7	19
1197 L	27	52	810226	33	4	11H 19 R	9	19	21H 597 R	49	..
1379	27	20	810601	33	27	11H 20 T	12	2	21H 717 T	44	..
1397	27	40	810620	33	52	11H 52 T	5	..	21H 928 T	49	..
1404	27	39	811553	33	3	11H 60 T	19	5	21H 930 T	49	..
1418	27	53	812015	31	61	11H 62 R	5	..	21H 931 T	49	..
1533	27	65		33	15	11H 64 T	5	..	21H 937 T	49	..
1760	27	25	812016	31	60	12H 7 R	19	14	21H 945 T	49	..
1814	29	42		33	19	12H 9 R	7	20	21H 961 R	31	20
2040	26	5	812406	33	26	12H 10 R	12	4	21H 962 R	27	46
	28	5	812407	33	28	12H 11 R	7	51	21H 964 R	27	49
2076	26	2	813521	33	5	12H 13 R	7	3	21H 966 R	27	63
2121	27	18	813554	33	22	12H 14 R	7	43	21H 969 R	33	21
2122	26	10	815018	31	5	12H 15 R	19	3	21H 971 R	23	22
	29	11	816331	31	55	12H 35 R	29	48	21H 973 R	27	34
2288	26	9	816911	33	34	12H 44 T	5	..	21H 977 R	23	51
	29	10	817216	31	14	12H 58 T	5	..	21H 983 R	31	68
2495	27	36	817220	31	9	12H 68 R	31	4	21H 985 R	31	2
2496	27	17	817223	31	44	14H 344 A	7	54	21H 986 R	33	7
2497	27	58	817224	31	43	14H 377 T	17	3	21H 988 R	26	14
2503	27	32	817313	31	62	14H 383 R	27	74	24H 66 A	43	32
2504	27	38		33	17	14H 402 T	42	25	24H 156 R	33	37
2505	27	21	817314	31	63	14H 463 T	37	21	24H 161 A	5	..
2537	27	61		33	16	14H 465 T	17	15	24H 379 T	36	9
2538	27	42				14H 466 T	25	..			
						14H 471 T	7	39			
						14H 477 T	7	..			



**NUMERICAL INDEX
MODEL "LI" TRACTOR**

Part No.	Page	Key	Part No.	Page	Key	Part No.	Page	Key	Part No.	Page	Key
24H 447 T	50	••	AL 2028 T	40	3	AL 2660 T	7	53	AL 2890 T	9	12
25H 42 T	15	1	AL 2066 T	45	1	AL 2663 T	7	50	AL 2891 T	9	12
25H 50 T	17	24	AL 2067 T	45	2	AL 2667 T	17	7	AL 2902 T	24	19
25H 73 T	39	46	AL 2079 T	42	1	AL 2668 J	15	7	AL 2919 T	25	?
25H 124 T	40	23	AL 2083 T	19	18	AL 2669 T	15	8	AL 2923 T	27	62
25H 125 T	9	29	AL 2087 T	24	1	AL 2675 T	11	7		29	68
25H 184 T	43	30	AL 2090 T	19	20	AL 2677 T	9	14	AL 2924 T	25	4
26H 6 R	15	3		21	9	AL 2687 T	19	••	AL 2925 T	46	••
26H 11 T	9	28	AL 2094 T	37	1	AL 2691 T	17	26	AL 2926 T	46	••
26H 14 R	42	24	AL 2095 T	37	2	AL 2692 T	17	8	AL 2927 T	46	••
26H 19 R	33	43	AL 2096 T	17	4	AL 2693 T	12	3	AL 2942 T	46	••
26H 72 R	31	46	AL 2116 T	37	3	AL 2699 T	9	21	AL 2943 T	46	••
29H 25 T	7	••	AL 2117 T	24	2	AL 2705 T	23	31	AL 2975 T	25	••
29H 483 R	24	9	AL 2118 T	24	3	AL 2715 T	39	9	AL 2976 T	25	5
30H 7 T	17	17	AL 2119 T	24	4	AL 2718 T	17	29	AL 4001 T	39	22
30H 17 R	7	48	AL 2122 T	39	1	AL 2720 T	17	••	AL 4004 T	39	6
30H 21 T	41	••	AL 2123 T	39	2	AL 2722 T	7	1	AL 4006 T	39	8
A 33X	27	16	AL 2124 T	45	1	AL 2723 T	33	53	AL 4007 T	39	10
A 140	27	73	AL 2130 T	43	2	AL 2725 T	17	9	AL 4011 T	39	47
A 179X	26	12	AL 2136 T	15	13	AL 2726 T	7	11	AL 4012 T	39	48
	29	13	AL 2156 T	43	3	AL 2728 T	15	10	AL 4016 T	39	49
A 243 A	26	11	AL 2159 T	39	3	AL 2729 T	15	16	AL 4022 T	39	16
A 243X	29	12	AL 2177 T	40	4	AL 2730 T	24	12	AL 4085 T	42	28
A 765 R	27	45	AL 2180 T	42	2	AL 2743 T	9	5	AL 4106 T	10	6
A 766 R	27	33	AL 2203 T	35	3	AL 2750 T	15	••	AL 4111 T	13	9
A 767 R	31	67	AL 2206 T	45	2	AL 2752 T	15	12	AL 4116 T	10	4
A 2784 R	33	44	AL 2209 T	36	1	AL 2753 T	17	20	AL 4123 T	37	23
A 2789 R	33	••	AL 2257 T	42	3	AL 2754 T	17	10	AL 4144 T	37	25
A 3008 R	31	7	AL 2258 T	42	4	AL 2755 T	17	11	AL 4145 T	37	26
A 3009 R	31	50	AL 2266 T	19	17	AL 2756 T	11	8	AL 4150 T	37	27
A 3011 R	31	27	AL 2267 T	24	18	AL 2757 T	24	10	AL 4173 T	15	6
A 3031 R	31	28	AL 2268 T	24	17	AL 2759 T	9	16	AL 4182 T	37	28
AA 3400 R	7	20	AL 2272 T	24	16	AL 2760 T	9	9	AL 4198 T	31	45
AA 3401 R	12	4	AL 2275 T	19	16	AL 2763 T	24	20	AL 4228 T	39	7
AA 3402 R	7	51		24	14	AL 2764 T	24	13	AL 4277 T	7	46
AA 3403 R	27	31	AL 2285 T	9	30	AL 2768 T	24	15	AL 4278 T	7	26
AA 3404 R	7	3	AL 2286 T	44	11	AL 2784 T	17	12	AL 4380 T	26	4
AA 3405 R	7	43	AL 2302 T	40	5	AL 2792 T	25	11		28	4
AA 3406 R	19	3	AL 2303 T	40	6	AL 2793 T	25	1	AL 4609 T	40	28
AA 3407 R	50	••	AL 2304 T	42	5	AL 2794 T	33	••	AL 4610 T	40	29
AA 3408 R	50	••	AL 2312 T	41	6	AL 2795 T	25	••	AL 4615 T	43	••
AA 3411 R	50	••	AL 2315 T	42	6	AL 2798 T	25	••	AL 4617 T	43	22
AA 3412 R	50	••	AL 2316 T	43	4	AL 2811 T	7	9	AL 4618 T	43	6
AA 3414 R	50	••	AL 2317 T	43	5	AL 2812 T	10	10	AL 20001 T	42	11
AA 3420 R	50	••	AL 2329 T	44	1	AL 2818 T	25	13	AL 20048 T	47	1
AA 3497 R	31	10	AL 2347 T	9	11	AL 2822 T	25	14		47	2
AB 1204 R	31	72	AL 2348 T	9	11	AL 2823 T	25	15		47	3
AB 2568 R	25	10	AL 2349 T	7	2	AL 2824 T	25	16		47	4
AD 1606 R	35	1	AL 2350 T	37	4	AL 2826 T	13	10		47	5
AF 2749 R	25	10	AL 2367 T	45	3	AL 2827 T	15	9		47	••
AL 116 T	37	11	AL 2377 T	46	1	AL 2834 T	13	3	AL 20110 T	42	12
AL 134 T	41	15	AL 2412 T	35	••	AL 2835 T	13	5	AL 20111 T	42	13
AL 136 T	41	16	AL 2417 T	45	4	AL 2836 T	13	4	AL 20112 T	42	••
AL 173 T	41	24	AL 2418 T	41	7	AL 2840 T	21	8	AL 20124 T	7	44
AL 174 T	41	28	AL 2421 T	9	32	AL 2841 T	7	29	AL 20125 T	40	8
AL 177 T	41	25	AL 2442 T	21	1	AL 2843 T	35	8	AL 20127 T	40	2
AL 368 T	42	15	AL 2444 T	21	6	AL 2845 T	39	11	AL 20129 T	40	••
AL 397 T	44	10	AL 2458 T	35	2	AL 2850 T	23	••	AL 20130 T	40	7
AL 608 T	44	9	AL 2464 T	35	4	AL 2855 T	25	2	AL 20131 T	40	4
AL 616 T	41	26	AL 2601 T	39	4	AL 2858 T	25	17	AL 20133 T	21	3
AL 619 T	41	17	AL 2603 T	39	5	AL 2859 T	42	11	AL 20139 T	43	4
AL 638 T	43	22	AL 2605 T	39	14	AL 2860 T	19	12	AL 20141 T	43	5
AL 657 T	43	6	AL 2614 T	36	2	AL 2862 T	19	6	AL 20142 T	43	1
AL 766 T	9	22	AL 2631 T	42	7	AL 2864 T	19	13	AL 20143 T	42	••
AL 787 T	11	9	AL 2632 T	42	8	AL 2866 T	36	3	AL 20149 T	43	7
AL 821 T	11	2	AL 2634 T	42	12	AL 2869 T	9	17	AL 20150 T	43	8
AL 822 T	11	1	AL 2635 T	42	13	AL 2871 T	7	22	AL 20157 T	43	5
AL 884 T	24	5	AL 2636 T	42	9	AL 2877 T	9	27	AL 20160 T	43	9
AL 968 T	46	6	AL 2639 T	42	10	AL 2878 T	40	7	AL 20161 T	43	4
AL 2011 T	4	1	AL 2645 T	43	8	AL 2881 T	9	20	AL 20173 T	43	8
AL 2013 T	41	5	AL 2651 T	10	9	AL 2882 T	9	8	AL 20244 T	42	••
AL 2015 T	43	1	AL 2653 T	9	26	AL 2883 T	9	20	AL 20274 T	29	••
AL 2016 T	41	1	AL 2654 T	9	1	AL 2884 T	9	8	AL 20275 T	42	12
AL 2017 T	41	2	AL 2657 T	12	7	AL 2885 T	9	20			
AL 2020 T	41	3	AL 2659 T	37	5	AL 2886 T	9	8			
AL 2021 T	41	4									



NUMERICAL INDEX MODEL "LI" TRACTOR

Part No.	Page	Key	Part No.	Page	Key	Part No.	Page	Key	Part No.	Page	Key
AL 20293 T	37	13	L 178 T	40	11	L 586 T	44	14	L 4037 T	39	54
AL 20294 T	4	10	L 198 T	40	12	L 587 T	23	11	L 4038 T	39	54
AL 20295 T	4	14	L 207 T	40	13	L 602 T	24	11	L 4039 T	39	36
AL 20305 T	21	2	L 211 T	40	15	L 609 T	36	••	L 4040 T	39	36
AL 20306 T	21	7	L 221 T	45	•••	L 633 T	39	43	L 4041 T	39	36
AM 514 T	1	7	L 225 T	45	8	L 646 T	45	8	L 4045 T	44	12
AM 669 T	7	8	L 226 T	45	8	L 647 T	43	21	L 4054 T	36	11
AM 1535 T	1	7	L 227 T	45	8	L 659 T	43	23	L 4058 T	36	12
AM 1536 T	1	7	L 256 T	40	••	L 660 T	43	24	L 4069 T	44	13
AM 1597 T	13	8	L 258 T	40	16	L 661 T	43	25	L 4077 T	42	34
AM 3257 T	25	2	L 273 T	36	4	L 668 T	43	25	L 4080 T	42	27
AT 195 T	9	1	L 282 T	45	3	L 669 T	43	25	L 4086 T	42	29
B 1085 R	27	54	L 286 T	45	4	L 678 T	40	21	L 4087 T	42	30
	29	56	L 288 T	45	5	L 681 T	40	22	L 4088 T	42	31
B 1107 R	27	75	L 294 T	45	6	L 682 T	9	13	L 4091 T	42	32
E 2302 RT	31	13	L 295 T	45	7	L 689 T	23	1	L 4092 T	42	33
F 690 R	25	••	L 297 T	45	7	L 752 T	35	7	L 4115 T	9	25
H 666 R	26	15	L 299 T	45	9	L 754 T	7	21	L 4117 T	10	5
	29	17	L 307 T	37	14	L 768 T	7	13	L 4121 T	7	40
IVA 583	26	7	L 308 T	40	17	L 779 T	7	7		15	4
	29	8	L 324 T	37	15	L 780 T	9	23	L 4122 T	7	6
IXA 256	27	44	L 333 T	40	18	L 789 T	9	18	L 4126 T	7	25
	29	34	L 338 T	37	16	L 803 T	9	18		9	4
	29	66	L 346 T	40	19	L 820 T	11	10		37	24
JD 7180 R	31	40	L 348 T	40	••	L 825 T	9	15	L 4127 T	9	7
JD 7209 R	41	11	L 348 T	19	21	L 826 T	15	2	L 4128 T	7	41
JD 7212 H	37	6	L 357 T	21	10	L 831 T	11	5	L 4129 T	7	56
	39	20	L 359 T	19	19	L 836 T	11	6		17	21
	45	5	L 365 T	19	1	L 851 T	11	3	L 4132 T	9	6
JD 7243 T	37	7	L 372 T	27	29	L 852 T	7	34	L 4133 T	12	1
	41	8	L 373 T	29	29	L 853 T	7	33	L 4134 T	7	49
	44	4	L 374 T	37	17	L 872 T	15	11	L 4135 T	7	28
	45	6	L 389 T	40	20	L 876 T	7	27	L 4136 T	10	8
JD 7250 R	43	11	L 408 T	40	24	L 885 T	7	32	L 4139 T	13	7
	44	3	L 409 T	7	22	L 886 T	27	31	L 4140 T	7	24
JD 7259 R	41	12	L 410 T	27	5	L 893 T	29	41	L 4151 T	13	6
JD 7262 R	37	8	L 417 T	13	1	L 908 T	7	16	L 4152 T	9	24
	39	21	L 418 T	36	6	L 955 T	24	6	L 4158 T	17	23
	41	10	L 419 T	36	7	L 964 T	24	7	L 4161 T	7	55
	44	5	L 420 T	36	8	L 966 T	24	8	L 4164 T	7	57
	45	7	L 422 T	39	29	L 985 T	19	11	L 4168 T	7	••
JD 7358 R	43	10	L 424 T	43	14	L 987 T	42	22	L 4176 T	17	18
	44	2	L 425 T	43	15	L 989 T	46	3	L 4177 T	17	30
JD 7372 T	41	9	L 426 T	43	16	L 995 T	46	5	L 4179 T	7	47
JD 7395 R	41	13	L 427 T	43	17	L 997 T	46	7	L 4181 T	17	27
JD 7397 T	39	23	L 428 T	43	18	L 1121 T	46	8	L 4183 T	7	36
JD 7399 T	39	25	L 446 T	43	19	L 1147 T	42	23		17	19
JD 7418 R	41	14	L 447 T	42	20	L 1148 T	21	5	L 4186 T	37	29
JD 7421 T	39	24	L 448 T	29	27	L 1149 T	21	5	L 4187 T	9	3
JD 7423 T	39	26	L 467 T	42	16		21	5	L 4188 T	17	28
JD 7428 R	39	28	L 468 T	42	17	L 1203 T	35	••	L 4192 T	21	11
JD 7754	35	••	L 495 T	19	4	L 1211 T	19	4	L 4197 T	17	5
JD 7759	37	9	L 496 T	27	30	L 1217 T	27	30	L 4199 T	31	69
	4	9	L 497 T	29	27	L 4017 T	29	27	L 4200 T	31	70
	42	14	L 498 T	35	••	L 4018 T	35	••	L 4201 T	31	71
	43	12	L 499 T	39	30	L 4019 T	45	••	L 4208 T	9	10
JD 7760	43	13	L 500 T	50	••	L 4020 T	50	••	L 4223 T	37	30
JD 7797	43	12	L 505 T	50	••	L 4021 T	50	••	L 4225 T	7	23
JD 8106 R	39	27	L 506 T	25	••	L 4022 T	25	••	L 4230 T	37	31
K 6445	28	7	L 534 T	50	••	L 4023 T	50	••	L 4231 T	17	22
L 105 T	44	6	L 535 T	50	••	L 4024 T	50	••	L 4232 T	7	12
L 106 T	44	7	L 536 T	25	••	L 4025 T	25	••	L 4233 T	7	14
L 113 T	37	10	L 537 T	25	••	L 4026 T	39	50	L 4241 T	7	42
L 114 T	37	10	L 538 T	39	39	L 4027 T	39	51	L 4244 T	17	2
L 115 T	37	10	L 539 T	39	39	L 4029 T	39	31	L 4246 T	33	54
L 117 T	37	12	L 542 T	39	39	L 4030 T	39	52	L 4247 T	33	••
L 137 T	41	18	L 543 T	39	42	L 4031 T	39	52	L 4248 T	36	13
L 139 T	41	20	L 544 T	39	••	L 4032 T	39	15	L 4252 T	17	13
L 140 T	41	21	L 547 T	37	18	L 4033 T	39	32	L 4256 T	7	18
L 157 T	41	23	L 552 T	37	18	L 4034 T	39	33	L 4263 T	7	17
L 158 T	41	23		45	10	L 4035 T	39	19	L 4265 T	17	16
L 159 T	41	23		45	10	L 4036 T	39	17	L 4266 T	7	45
L 160 T	41	19		37	19		39	53	L 4281 T	33	55
L 161 T	41	19		37	20		39	35	L 4287 T	33	56
L 162 T	41	19		37	20		39	34	L 4289 T	49	••
L 163 T	41	22		37	20		39	18	L 4290 T	10	1
L 169 T	41	27		35	5		39	54			
				35	6						

**NUMERICAL INDEX
MODEL "LI" TRACTOR**

Part No.	Page	Key	Part No.	Page	Key	Part No.	Page	Key	Part No.	Page	Key
L	4291	T									
L	4294	T									
L	4299	T									
L	4311	T									
L	4312	T									
L	4316	T									
L	4343	T									
L	4349	T									
L	4350	T									
L	4352	T									
L	4353	T									
L	4362	T									
L	4363	T									
L	4366	T									
L	4367	T									
L	4368	T									
L	4406	T									
L	4433	T									
L	4434	T									
L	4435	T									
L	4436	T									
L	4571	T									
L	4583	T									
L	4584	T									
L	4590	T									
L	4593	T									
L	4601	T									
L	4602	T									
L	4603	T									
L	4613	T									
L	4619	T									
L	4620	T									
L	4621	T									
L	4622	T									
L	4624	T									
L	4633	T									
L	4734	T									
L	4789	T									
L	4796	T									
M	2 D										
M	33X										
M	34X										
M	35X										
M	42XA										
M	72X										
M	534 T										
M	824 T										
M	1437 T										
X	1413										
X	2286										
X	2706										
X	2719										
X	2721A										
X	2725										
X	2747										
X	2766										
X	2798										
X	2919										
X	3194										
X	3343										
X	3872										
X	4603										
X	5521										
X	5524										
X	5531										
X	5549										
X	5614										
X	5632										
X	5700										
X	5757										
X	5769										
X	5996										
X	6000										
X	6501										
Y	5761										